

**Characteristics**

- High reliability PLCC-2 package
- High optical efficiency
- Toyoda Gosei InGaN core emitter
- Silicone encapsulation

**Directive Characteristics (Ta=25°C)**

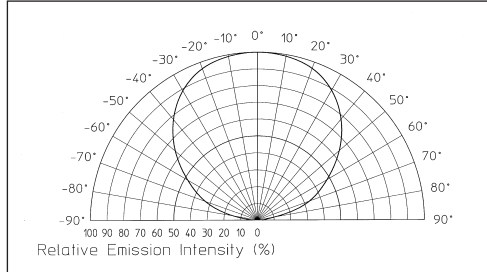

**Package Outlines (mm)**

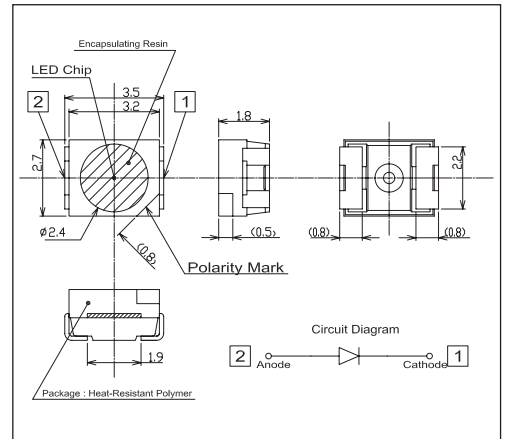

**Absolute Rating Limits (Ta=25°C)**

Item	Symbol	Value	Unit
Power Dissipation	$P_D$	120	mW
DC Forward Current	$I_F$	30	mA
DC Reverse Voltage	$V_R$	5	V
Operating Temperature	$T_{opr}$	-40 ~ +100	°C
Storage Temperature	$T_{stg}$	-40 ~ +100	°C

**Recommended Soldering Pattern (mm)**

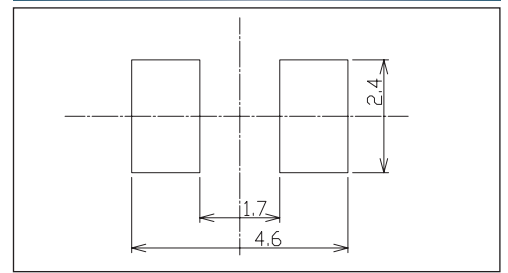

**Electrical and Optical Characteristics (Ta=25°C)**

Part No.	Luminous Intensity [mcd]			Forward Voltage [V]		
	Typ.	Min.	$I_F$ [mA]	Typ.	Max.	$I_F$ [mA]
PX-1T455-W	1500	820	20	3.3	3.7	20

**Luminous Intensity Ranks (Ta=25°C)**

Luminous Intensity [mcd] at $I_F=20\text{mA}$					
Rank	Rank	Rank	Rank	Rank	Rank
O	820 ~ 1200	P	1200 ~ 1800	Q	1800 ~ 2700

**Chromaticity Ranks (Ta=25°C,  $I_F=20\text{mA}$ )**

Rank	x	y	Rank	x	y
1	0.2500	0.2600	5	0.3150	0.3600
	0.2660	0.2860		0.3325	0.3850
	0.3000	0.2690		0.3600	0.3700
	0.2850	0.2400		0.3450	0.3450
2	0.2660	0.2860	6	0.3125	0.3300
	0.2825	0.3105		0.3274	0.3538
	0.2970	0.3040		0.3450	0.3450
	0.2820	0.2780		0.3300	0.3200
3	0.2825	0.3105	7	0.2970	0.3040
	0.3000	0.3375		0.3125	0.3300
	0.3125	0.3300		0.3300	0.3200
	0.2970	0.3040		0.3150	0.2950
4	0.3000	0.3375	8	0.2820	0.2780
	0.3150	0.3600		0.2970	0.3040
	0.3274	0.3538		0.3150	0.2950
	0.3125	0.3300		0.3000	0.2690

**Taping Outline Dimensions (Unit: mm)**

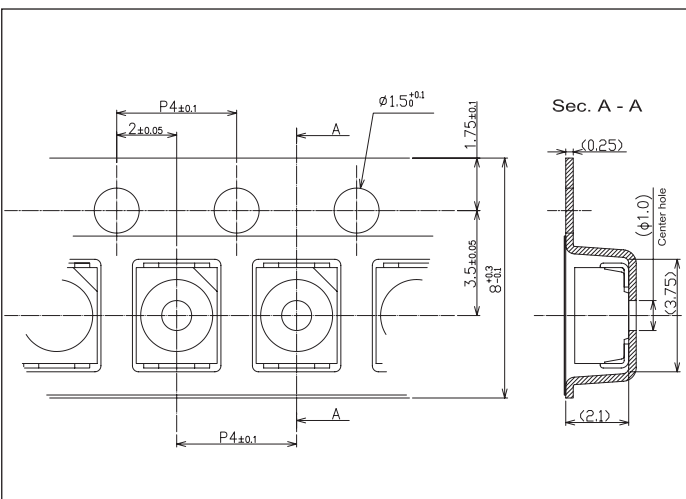

**Package**

Reel	2000 pieces / reel
------	--------------------

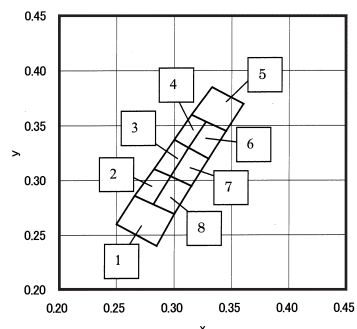

Typical Characteristics

