

# RS SERIES ROTARY SWITCHES



## SPECIFICATIONS

**VOLTAGE RATING:** 150 VDC  
**CURRENT RATING:** 130 mA  
**INSULATION RESISTANCE:** 100M  $\Omega$  Min  
**INDEXING ANGLE:** 30°  
**OPERATING LIFE NO LOAD:** 20,000CYCLES Min.  
**OPERATING LIFE AT MAXPOWER:** 15,000CYCLES Min.  
**SWITCHING MODE:** Shorting and non shorting.  
**SOLDER SPECIFICATIONS:** 250°C for 5 seconds.  
**CONTACT RESISTANCE:** 25m  $\Omega$  Max(initial)  
**OPERATING FORCE:** 1kgf.cm(Max).



## HOW TO ORDER

Model No.	Actuator No	Switching Combination	Contacts
RS5	A=Excessed B=Recessed C=Excessed (WITH AL SHAFT)	11 31 61 12 32 63 13 33 21 41 22 42 23 43	YS= SHORTING NS= NON SHORTING

RS5

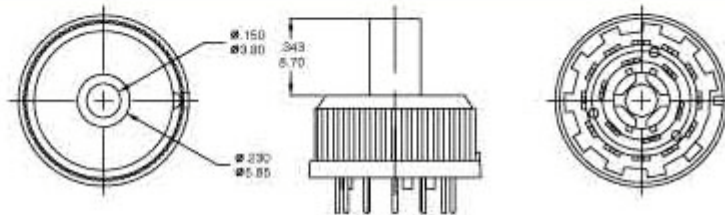

## ACTUATOR OPTIONS

A

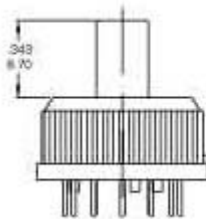



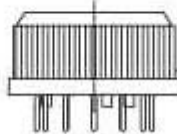



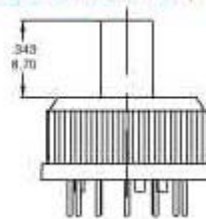



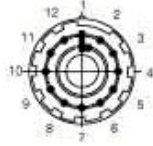
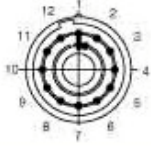

B

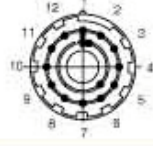

C (WITH AL SHAFT)



## SWITCHING COMBINATION

<b>11</b> 1 pole 1*2 	<b>12</b> 1 pole 1*12 	<b>13</b> 1 pole without stop 
<b>21</b> 2 pole 2*2 	<b>22</b> 2 pole 2*6 	<b>23</b> 2 pole without stop 
<b>31</b> 3 pole 3*2 	<b>32</b> 3 pole 3*4 	<b>33</b> 3 pole without stop 
<b>41</b> 4 pole 4*2 	<b>42</b> 4 pole 4*3 	<b>43</b> 4 pole without stop 
<b>61</b> 6 pole 6*2 		<b>63</b> 6 pole without stop 

## PCB MOUNTING

