

Pitch: 9.52mm(0.375inch)



## SPECIFICATIONS

			CUL	VDE
負載電壓	Rated Voltage	Bemessungsspannung	AC 600V	AC 600V
負載電流	Rated Current	Bemessungsstrom	30A	25A
電線線徑	Wire Size	Leitergrößen	24~10AWG	0.5~6mm <sup>2</sup>
塑膠本體	Housing Material	Isolierstofftyp	Polyamide66(UL94V-0)	
押線圈	Cage Clamp	Klemmkörper	Steel, Ni plated	
端子	Terminal	Stiftmaterial	Brass, Tin plated	
螺絲	Screw Size	Schraubengewinde	M3.0, steel, Ni plated	
操作溫度	Operating Temperature	Umgebungstemperatur	-40°C to + 105°C	
扭力	Torque	Anzugsmoment	9.0 lb-inch	
PC板孔徑	PCB Hole Diameter	Lochdurchmesser	φ 1.7mm	
UL File No.	E167040			

## TABLE

Item No.	A(mm)	A(inch)
MB920-952M02	19.0	0.750
MB920-952M03	28.6	1.124

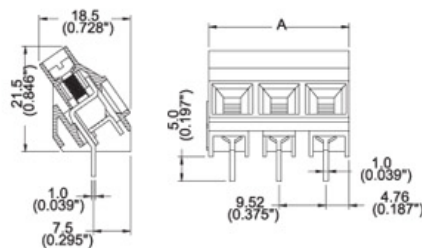

## PCB Layout

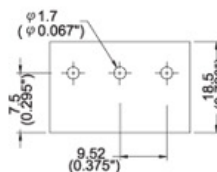

### Note:

Screw Plating: Changes are available upon request  
Cage Clamp: MB922: Brass