

## Montagearten (FP)

Bauhöhe 7.4 mm für Lötstift 90°, 9.4 mm (YC)

## Assemblies (FP)

Mounting height 7.4 mm for solder pin 90°, 9.4 mm (YC)

### M46 x

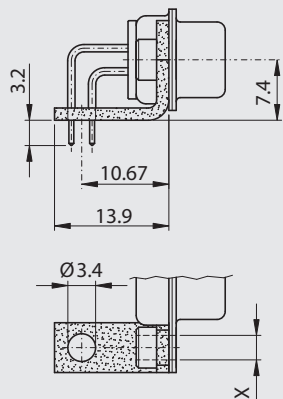

Metallwinkel / Metal bracket

**M46 D3** Niete / rivet Ø 3.1 mm

**M46 UN** Niete / back nut UNC4-40

**M46 M3** Niete / back nut M3

### M46 xx

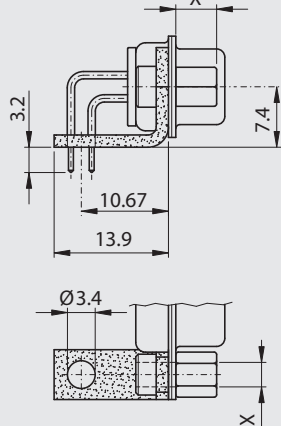

Metallwinkel / Metal bracket

**M46 UN B5** Niete / back nut UNC4-40

Schraube / screw 5 mm

**M46 UN B6** Niete / back nut UNC4-40

Schraube / screw 6 mm

**M46 M3 B5** Niete / back nut M3

Schraube / screw 5 mm

**M46 M3 B6** Niete / back nut M3

Schraube / screw 6 mm

### M47 x

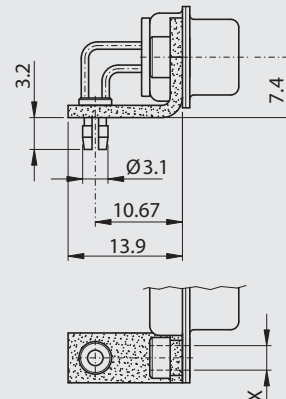

Metallwinkel mit P.o.F.  
Metal bracket with P.o.F.

**M47 D3** Niete / rivet Ø 3.1 mm

**M47 UN** Niete / back nut UNC4-40

**M47 M3** Niete / back nut M3

### M47 xx

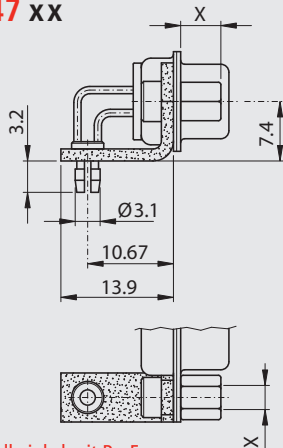

Metallwinkel mit P.o.F.  
Metal bracket with P.o.F.

**M47 UN B5** Niete / back nut UNC4-40

Schraube / screw 5 mm

**M47 UN B6** Niete / back nut UNC4-40

Schraube / screw 6 mm

**M47 M3 B5** Niete / back nut M3

Schraube / screw 5 mm

**M47 M3 B6** Niete / back nut M3

Schraube / screw 6 mm

### M48 x

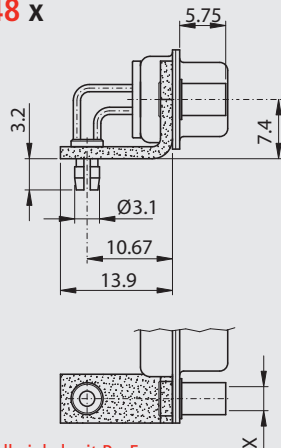

Metallwinkel mit P.o.F.  
Metal bracket with P.o.F.

**M48 UN** Niete / front nut UNC4-40

**M48 M3** Niete / front nut M3

### M49 x

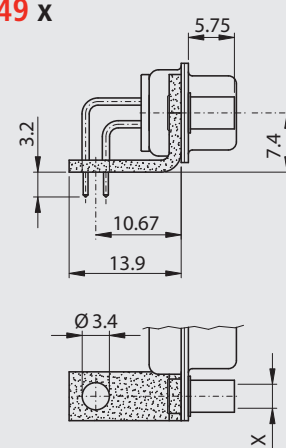

Metallwinkel / Metal bracket

**M49 UN** Niete / front nut UNC4-40

**M49 M3** Niete / front nut M3



## Montagearten (FP)

Bauhöhe 7.4 mm für Lötstift 90°, 9.4 mm (YC)

## Assemblies (FP)

Mounting height 7.4 mm for solder pin 90°, 9.4 mm (YC)

### M63 x

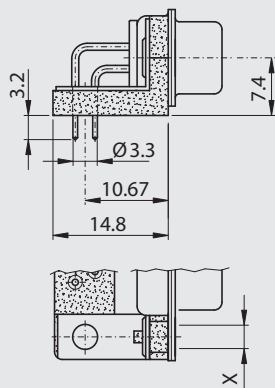

Kunststoffwinkel mit Erdungswinkel  
Plastic bracket with ground strap

<b>M63 D3</b>	Niete / rivet	Ø 3.1 mm
<b>M63 UN</b>	Niete / back nut	UNC4-40
<b>M63 M3</b>	Niete / back nut	M3

### M63 xx

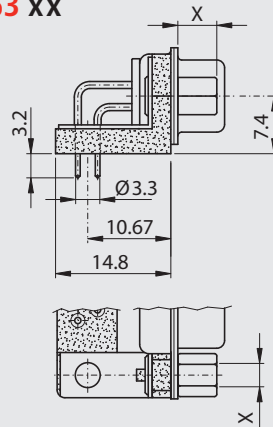

Kunststoffwinkel mit Erdungswinkel  
Plastic bracket with ground strap

<b>M63 UN B5</b>	Niete / back nut	UNC4-40
	Schraube / screw	5 mm
<b>M63 UN B6</b>	Niete / back nut	UNC4-40
	Schraube / screw	6 mm
<b>M63 M3 B5</b>	Niete / back nut	M3
	Schraube / screw	5 mm
<b>M63 M3 B6</b>	Niete / back nut	M3
	Schraube / screw	6 mm

### M64 x

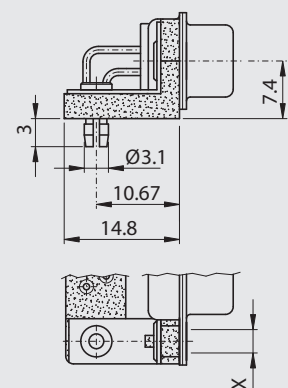

Kunststoffwinkel mit Erdungswinkel und P.o.F.  
Plastic bracket with ground strap and P.o.F.

<b>M64 D3</b>	Niete / rivet	Ø 3.1 mm
<b>M64 UN</b>	Niete / back nut	UNC4-40
<b>M64 M3</b>	Niete / back nut	M3

### M64 xx

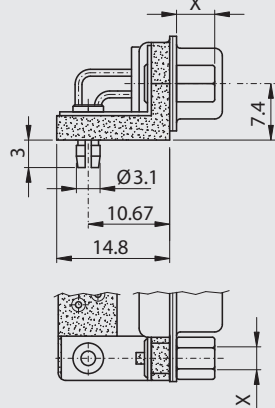

Kunststoffwinkel mit Erdungswinkel und P.o.F.  
Plastic bracket with ground strap and P.o.F.

<b>M64 UN B5</b>	Niete / back nut	UNC4-40
	Schraube / screw	5 mm
<b>M64 UN B6</b>	Niete / back nut	UNC4-40
	Schraube / screw	6 mm
<b>M64 M3 B5</b>	Niete / back nut	M3
	Schraube / screw	5 mm
<b>M64 M3 B6</b>	Niete / back nut	M3
	Schraube / screw	6 mm

### M61 x

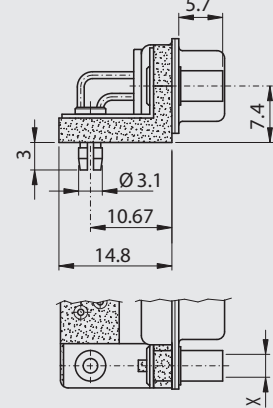

Kunststoffwinkel mit Erdungswinkel und P.o.F.  
Plastic bracket with ground strap and P.o.F.

<b>M61 UN</b>	Niete / front nut	UNC4-40
<b>M61 M3</b>	Niete / front nut	M3

### M66 x

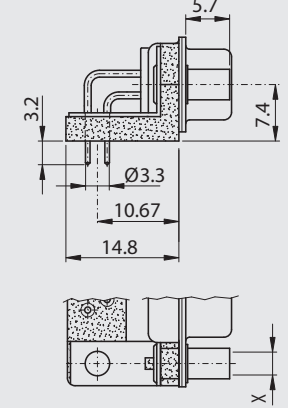

Kunststoffwinkel mit Erdungswinkel  
Plastic bracket with ground strap

<b>M66 UN</b>	Niete / front nut	UNC4-40
<b>M66 M3</b>	Niete / front nut	M3

Die Montagen M64 x(x) und M61 x  
sind auch mit Z-Shape erhältlich.  
Assemblies M64 x(x) and M61 x  
are available also with z-shape.

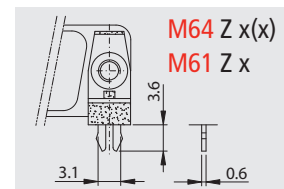

## Montagearten (FP)

Bauhöhe 7.4 mm für Lötstift 90°, 9.4 mm (YC)

## Assemblies (FP)

Mounting height 7.4 mm for solder pin 90°, 9.4 mm (YC)

### M74 x

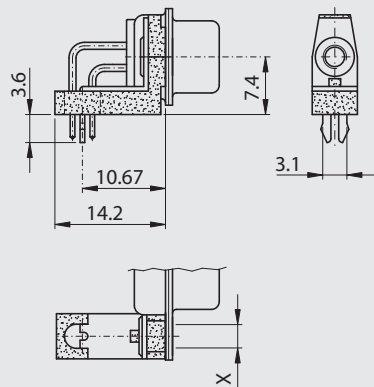

Kunststoffwinkel mit Erdungswinkel (Z)  
Plastic bracket with ground strap (Z)

**M74 UN** Niete / back nut UNC4-40

**M74 M3** Niete / back nut M3

### M74 xx

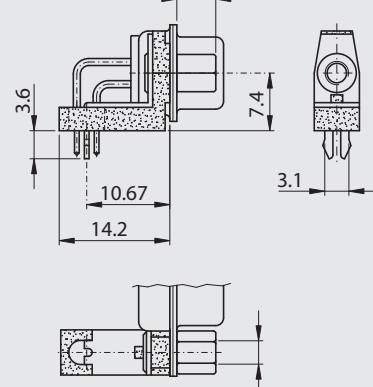

Kunststoffwinkel mit Erdungswinkel (Z)  
Plastic bracket with ground strap (Z)

**M74 UN B5** Niete / back nut UNC4-40

Schraube / screw 5 mm

**M74 UN B6** Niete / back nut UNC4-40

Schraube / screw 6 mm

**M74 M3 B5** Niete / back nut M3

Schraube / screw 5 mm

**M74 M3 B6** Niete / back nut M3

Schraube / screw 6 mm