

# Montagearten; Bauhöhe 6.3 mm

Für Lötstift 90°, 7.18 mm (YCA)

# Assemblies; mounting height 6.3 mm

For solder pin 90°, 7.18 mm (YCA)

## M46A x

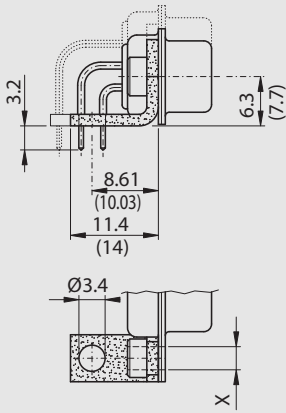

Metallwinkel / Metal bracket

M46A D3 Niete / rivet Ø 3.1 mm

M46A UN Niete / back nut UNC4-40

M46A M3 Niete / back nut M3

## M46A xx

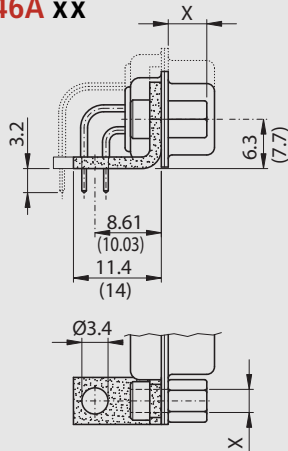

Metallwinkel / Metal bracket

M46A UN B5 Niete / back nut UNC4-40

Schraube / screw 5 mm

M46A UN B6 Niete / back nut UNC4-40

Schraube / screw 6 mm

M46A M3 B5 Niete / back nut M3

Schraube / screw 5 mm

M46A M3 B6 Niete / back nut M3

Schraube / screw 6 mm

## M47A x

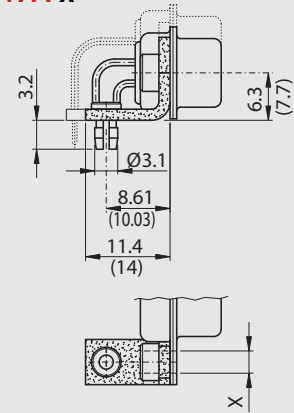

Metallwinkel mit P.o.F.  
Metal bracket with P.o.F.

M47A D3 Niete / rivet Ø 3.1 mm

M47A UN Niete / back nut UNC4-40

M47A M3 Niete / back nut M3

## M47A xx

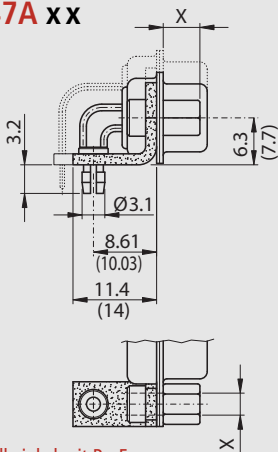

Metallwinkel mit P.o.F.  
Metal bracket with P.o.F.

M47A UN B5 Niete / back nut UNC4-40

Schraube / screw 5 mm

M47A UN B6 Niete / back nut UNC4-40

Schraube / screw 6 mm

M47A M3 B5 Niete / back nut M3

Schraube / screw 5 mm

M47A M3 B6 Niete / back nut M3

Schraube / screw 6 mm

## M48A x

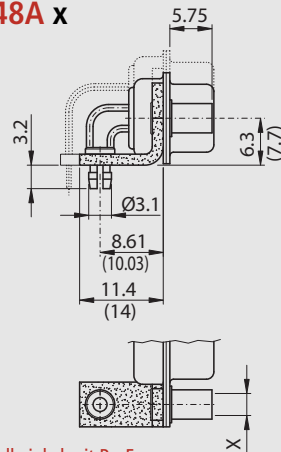

Metallwinkel mit P.o.F.  
Metal bracket with P.o.F.

M48A UN Niete / front nut UNC4-40

M48A M3 Niete / front nut M3

## M49A x

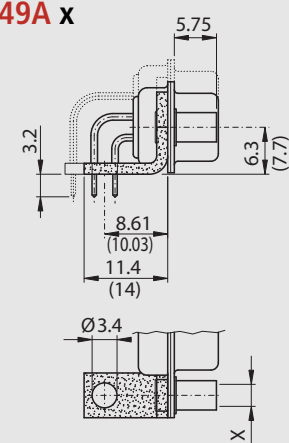

Metallwinkel / Metal bracket

M49A UN Niete / front nut UNC4-40

M49A M3 Niete / front nut M3