

# Montagearten; Bauhöhe 3.6 mm

Für Lötstift Eurostyle, 8.4 mm (YCE)

# Assemblies; mounting height 3.6 mm

For solder pin Eurostyle, 8.4 mm (YCE)

Kundenspezifische Ausführungen  
auf Anfrage  
Customer specified products  
on request



## M446 x

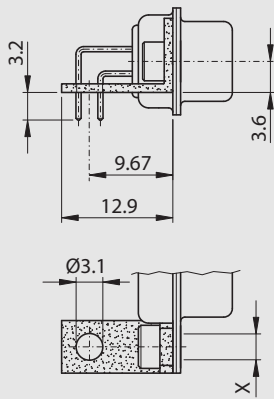

Metallwinkel / Metal bracket

M446 D3 Niete / rivet Ø 3.1 mm

M446 UN Niete / back nut UNC4-40

M446 M3 Niete / back nut M3

## M446 xx

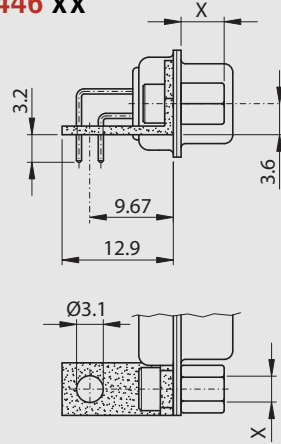

Metallwinkel / Metal bracket

M446 UN B5 Niete / back nut UNC4-40

Schraube / screw 5 mm

M446 UN B6 Niete / back nut UNC4-40

Schraube / screw 6 mm

M446 M3 B5 Niete / back nut M3

Schraube / screw 5 mm

M446 M3 B6 Niete / back nut M3

Schraube / screw 6 mm

## M447 x

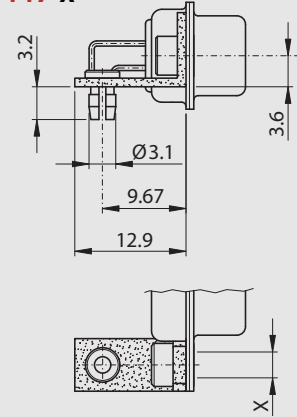

Metallwinkel mit P.o.F.  
Metal bracket with P.o.F.

M447 D3 Niete / rivet Ø 3.1 mm

M447 UN Niete / back nut UNC4-40

M447 M3 Niete / back nut M3

## M447 xx

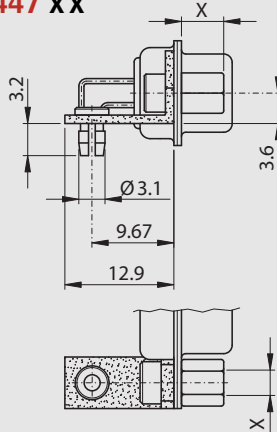

Metallwinkel mit P.o.F.  
Metal bracket with P.o.F.

M447 UN B5 Niete / back nut UNC4-40

Schraube / screw 5 mm

M447 UN B6 Niete / back nut UNC4-40

Schraube / screw 6 mm

M447 M3 B5 Niete / back nut M3

Schraube / screw 5 mm

M447 M3 B6 Niete / back nut M3

Schraube / screw 6 mm