

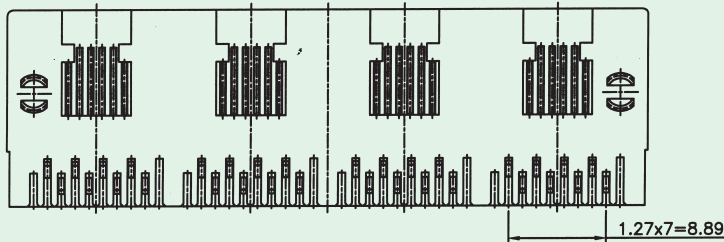

Side Entry PCB Jack (Multi-Port, RJ45, Unshielded)

KINSUN

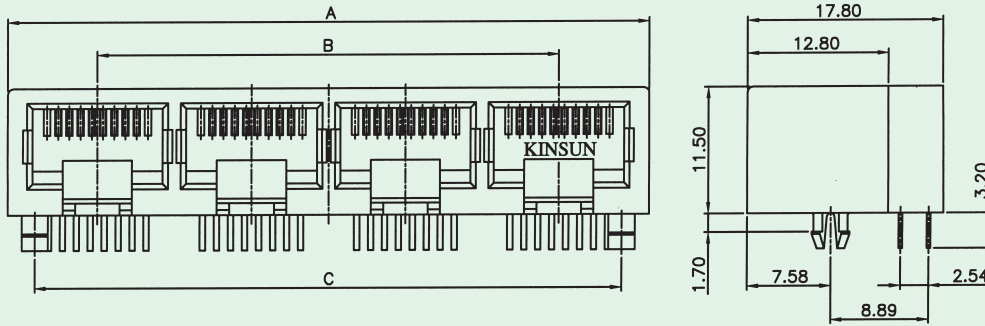

No. of Ports	Dimensions		
	A	B	C
2	30.38	13.97	25.40
4	58.32	41.91	53.34

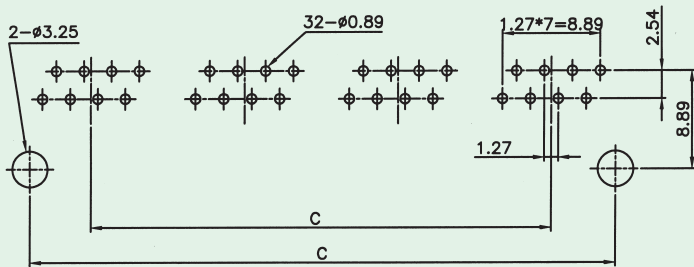

PCB Layout / Top View

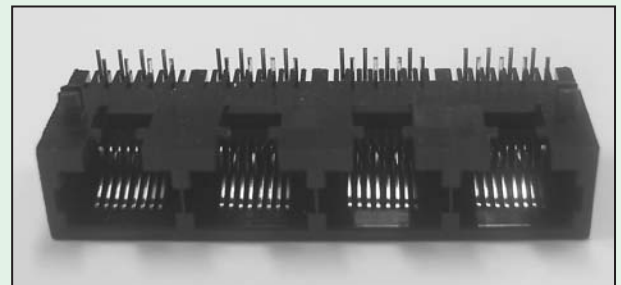

Materials

- **Housing** : Engineering Thermoplastic.
Flammability Rating UL 94V-0.
- **Contacts** : Phosphor Bronze.
- **Plating** : Gold Plating Over Nickel In Contact Area.
Tin Plating Over Nickel In Solder Area.

Ordering Information

