

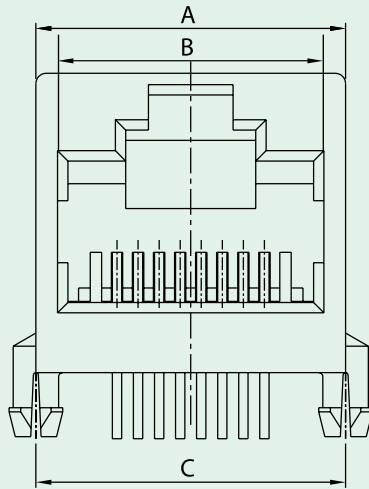

Side Entry PCB Jack (Up Latch)

KINSUN



PCB LAYOUT/TOP VIEW

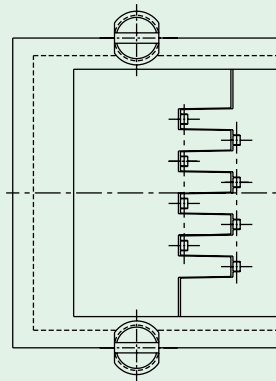
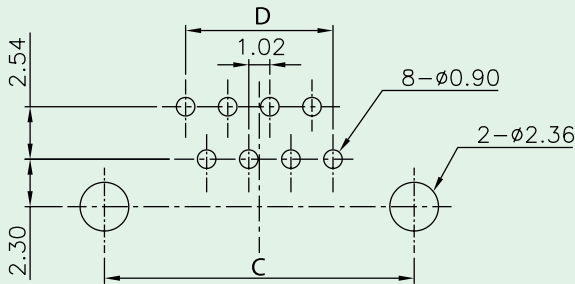
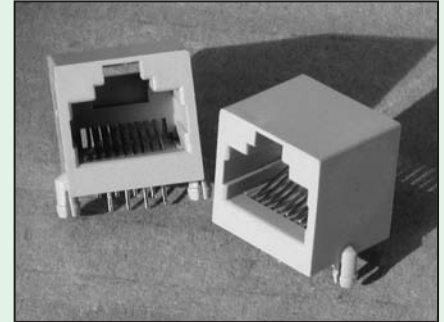
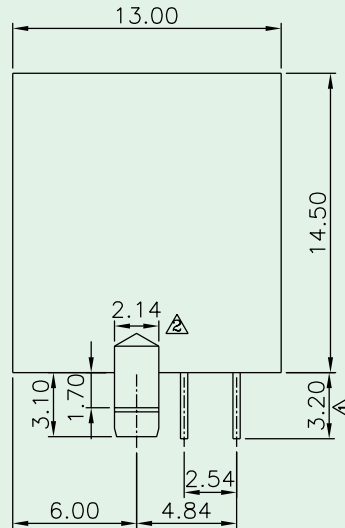

| No. of Positions | Dimensions | | | |
|------------------|------------|-------|-------|------|
| | A | B | C | D |
| 4 | 12.20 | 7.82 | 12.00 | 3.06 |
| 6 | 12.20 | 9.90 | 12.00 | 5.10 |
| 8 | 15.00 | 11.90 | 15.00 | 7.14 |
| 10 | 15.00 | 11.90 | 15.00 | 9.18 |

Materials

- **Housing** : Engineering Thermoplastic.
Flammability Rating UL 94V-0.
Standard Color : Black or Gray.
- **Contacts** : Phosphor Bronze.
- **Plating** : Gold Plating Over Nickel In Contact Area.
Tin Plating Over Nickel In Solder Area.

Ordering Information

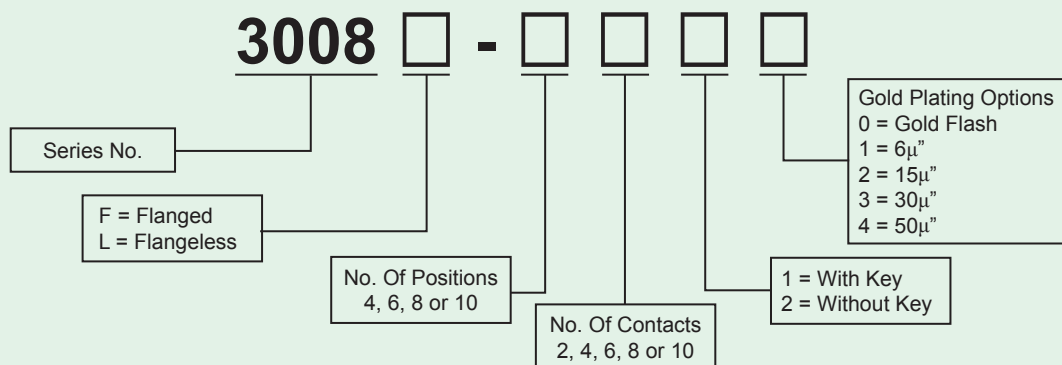

Options: With Short-Circuit Contact Available