

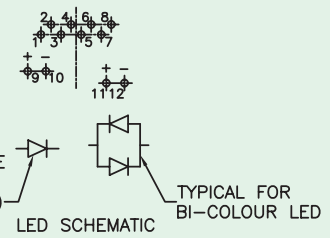

Side Entry PCB Jack Shielded With LED Multi-Port

KINSUN

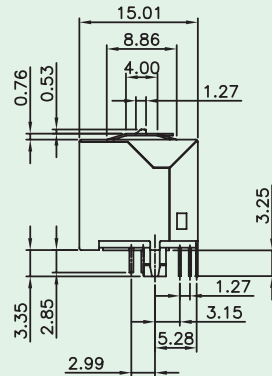
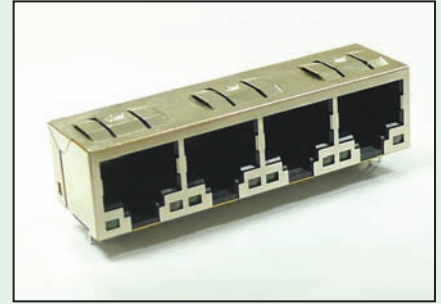
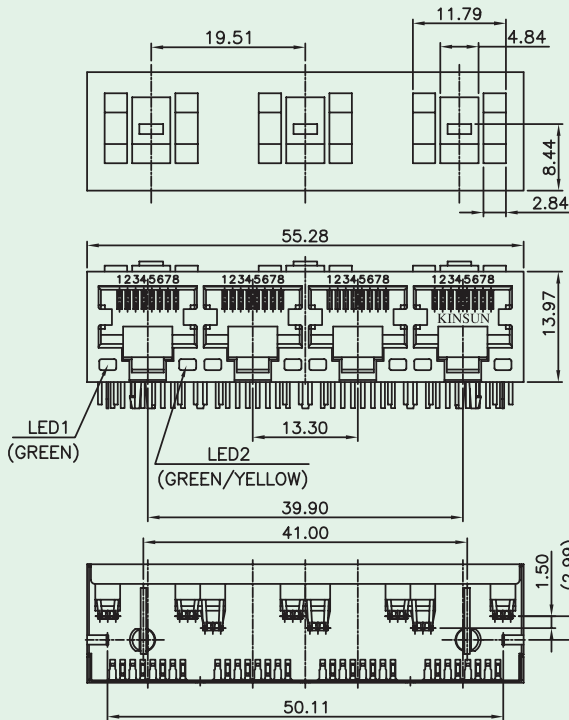

CODE	LED 2(RIGHT)	LED 1(LEFT)
0	NO LED	NO LED
1	YELLOW	GREEN
2	NO LED	GREEN
3	GREEN	YELLOW
4	GREEN	GREEN
5	YELLOW	YELLOW
6	YELLOW/GREEN	YELLOW/GREEN
7	GREEN/RED	GREEN/RED
8	YELLOW/GREEN	YELLOW

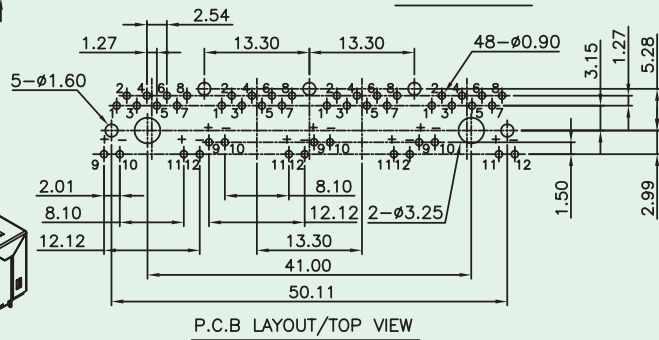
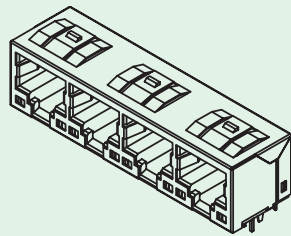

Materials

- **Shield** : Brass With Nickel Plated.
- **Housing** : Engineering Thermoplastic.
Flammability Rating UL 94V-0.
- **Contacts** : Phosphor Bronze.
- **Plating** : Gold Plating Over Nickel In Contact .
Tin Plating Over Nickel In Solder Area.

Ordering Information

