

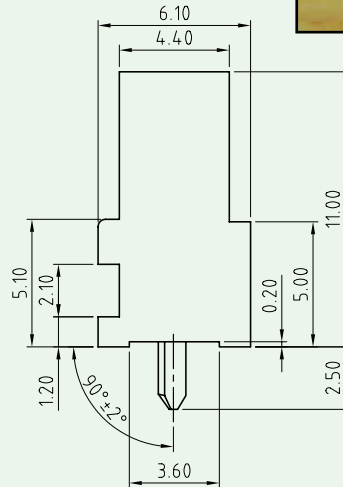

IDC Block (Mini Krone Type)

KINSUN

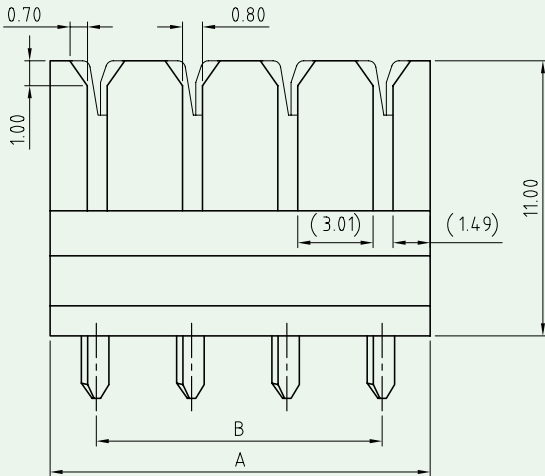
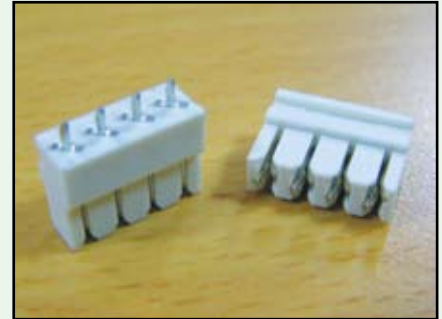
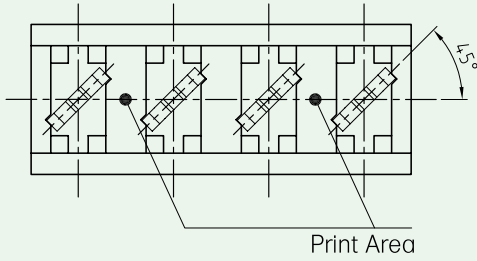

No. of Positions	Dimensions	
	A	B
2	7.58	3.81
4	15.20	11.43

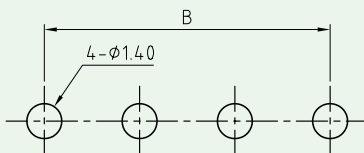

PCB Layout

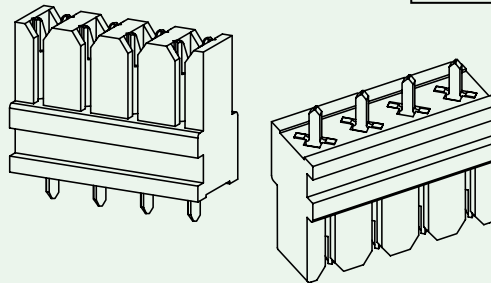

Materials

- **Insulator** : PC+30% Glass Fiber.
Flammability Rating UL 94V-0.
Standard Color : Ivory.
- **Pins** : 0.8mm Thickness Phosphor Bronze With Tin Plated Over Nickel.



Ordering Information

5804 -

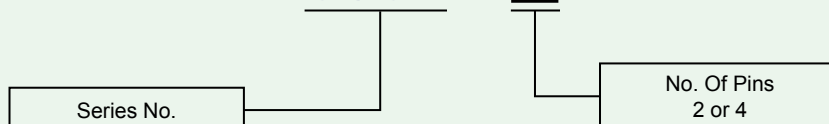

- **Color Options On Print Area Are Available.**