

**Ultraminiature PCB socket connectors**  
SMD mount

**Technical Specs (General specs see page 17):**

Insulator:	Black glass filled polyester PCT-GF30-FR
Flammability:	UL 94V-O
Sleeve:	Brass CuZn36Pb3 (C36000)
Contact clip (3 finger):	Beryllium copper (C17200)
Mating pin Ø:	0.35 to 0.50 mm
Forces:	(polished steel gauge Ø 0.41 mm)
– Insertion	0.5 N typ.
– Withdrawal	0.2 N typ.
Mechanical life:	min 500 cycles
Rated current:	1 A
Contact resistance:	max 20 mΩ
Dielectric strength:	min 500 V <sub>RMS</sub>
Coplanarity SMD terminations:	max 0.1 mm (measured on 25 mm long connectors)

For corresponding pin connectors see pages 25-28

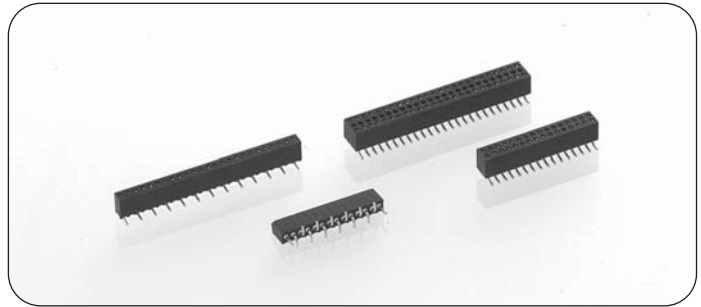

**Ordering information RoHS compliant parts**

PP Plating code	Sleeve	Clip
87	Tin	Gold flash
83	Tin	Gold 0.75 µm

Other plating on request see page 146 for plating specs

**NNN number of poles.** Replace **NNN** with the requested number of poles, e.g. 851-83-**NNN**-30-001101 for a single row version with 8 pins becomes 851-83-**008**-30-001101

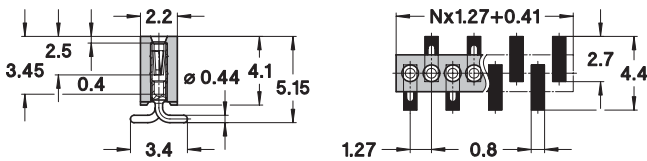

851-PP-NNN-30-001101

SMD socket connector: single row, perpendicular mount

Availability from: 3 to 50 contacts  
Standard number of contacts 25 and 50

For connectors having more than 19 contacts, the coplanarity issue is to be addressed specifically



T & R Packaging

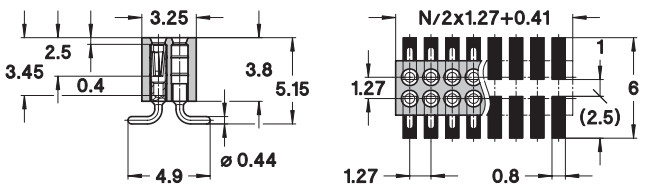

853-PP-NNN-30-001101

SMD socket connector: double row, perpendicular mount

Availability from: 4 to 100 contacts  
Standard number of contacts 50 and 100

For connectors having more than 19 contacts per row, the coplanarity issue is to be addressed specifically



T & R Packaging

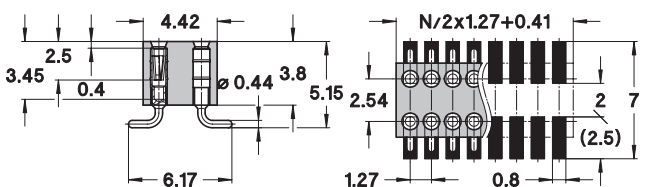

853-PP-NNN-30-002101

SMD socket connector: double row with 2.54 mm row to row distance, perpendicular mount

Availability from: 4 to 100 contacts  
Standard number of contacts 100

For connectors having more than 19 contacts per row, the coplanarity issue is to be addressed specifically



T & R Packaging

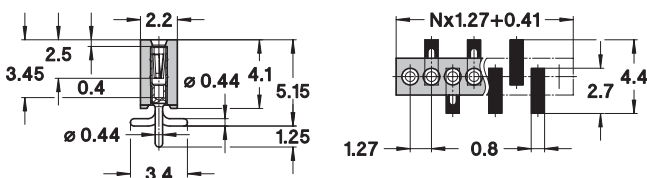

851-PP-NNN-30-136101

SMD socket connector: single row, perpendicular mount with 2 positioning pins

Availability from: 5 to 50 contacts  
Standard number of contacts 25 and 50

For connectors having more than 19 contacts, the coplanarity issue is to be addressed specifically

Due to technical progress, all the information provided is subject to change without prior notice



**Ultraminiature PCB socket connectors**  
SMD mount

**Technical Specs (General specs see page 17):**

Insulator:	Black glass filled polyester PCT-GF30-FR
Flammability:	UL 94V-O
Sleeve:	Brass CuZn36Pb3 (C36000)
Contact clip (3 finger):	Beryllium copper (C17200)
Mating pin Ø:	0.38 to 0.50 mm
Forces:	(polished steel gauge Ø 0.41 mm)
– Insertion	0.5 N typ.
– Withdrawal	0.2 N typ.
Mechanical life:	min 500 cycles
Rated current:	1 A
Contact resistance:	max 20 mΩ
Dielectric strength:	min 500 V <sub>RMS</sub>
Coplanarity SMD terminations:	max 0.1 mm (measured on 25 mm long connectors)

For corresponding pin connectors see pages 25-28

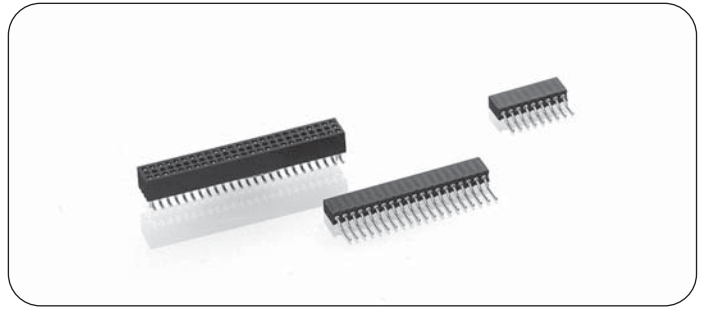

**Ordering information RoHS compliant parts**

PP Plating code	Sleeve	Clip
87	Tin	Gold flash
83	Tin	Gold 0.75 µm

Other plating on request see page 146 for plating specs

**NNN number of poles.** Replace **NNN** with the requested number of poles, e.g. 851-83-**NNN**-40-001101 for a single row version with 8 pins becomes 851-83-**008**-40-001101

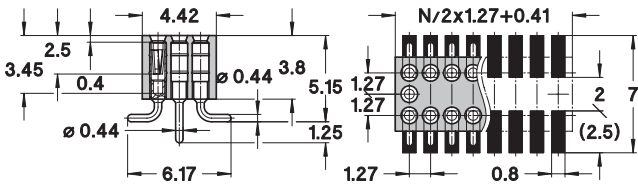

853-PP-NNN-30-051101

SMD socket connector: double row with 2.54 mm row to row distance, perpendicular mount with 2 positioning pins

Availability from: 4 to 100 contacts  
Standard number of contacts 100

For connectors having more than 19 contacts per row, the coplanarity issue is to be addressed specifically

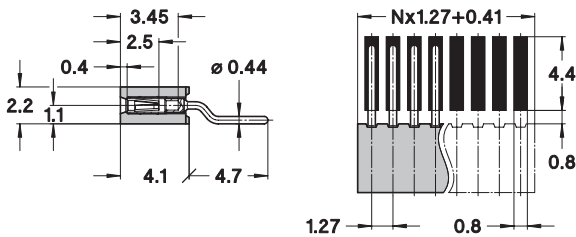

851-PP-NNN-40-001101

SMD socket connector: single row, parallel mount with long solder termination

Availability from: 2 to 50 contacts  
Standard number of contacts 25 and 50

For connectors having more than 19 contacts, the coplanarity issue is to be addressed specifically

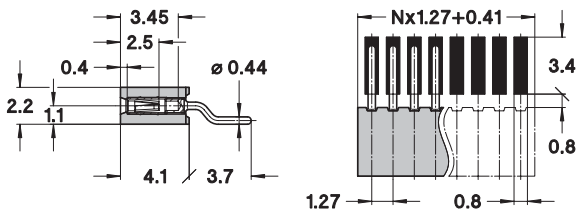

851-PP-NNN-40-252101

SMD socket connector: single row, parallel mount

Availability from: 2 to 50 contacts  
Standard number of contacts 25 and 50

For connectors having more than 19 contacts, the coplanarity issue is to be addressed specifically



T & R Packaging

