

HD D-Sub Steckverbinder, gewinkelt, Lötstifte HD D-Sub Connectors, Right-Angled, Solder Pins

Technische Daten / Technical Data

Gehäuse	Stahl vernickelt, verzinkt
Shell	Steel, tin coated over nickel
Isolierkörper	Thermoplastischer Kunststoff, nach UL94 V-0
Insulator	Thermoplastic, rated UL94 V-0
Kontaktmaterial	Kupferlegierung
Contact Material	Copper alloy
Kontaktoberfläche	Gold über Nickel
Contact Surface	Gold over nickel
Durchgangswiderstand	< 20mΩ
Contact Resistance	< 20mΩ
Isolationswiderstand	> 500MΩ
Insulation Resistance	> 500MΩ
Spannungsfestigkeit	500V _{AC}
Test Voltage	500V _{AC}
Nennstrom	3A
Current Rating	3A
Temperaturbereich	-55°C ... +125°C
Temperature Range	-55°C ... +125°C
Verarbeitung	Wellenlötverfahren
Processing	Wave soldering
Güteklasse	GK 3, min. 50 Steckzyklen, andere GK auf Anfrage
Quality Class	Quality class 3, min. 50 cycles, more quality options on request

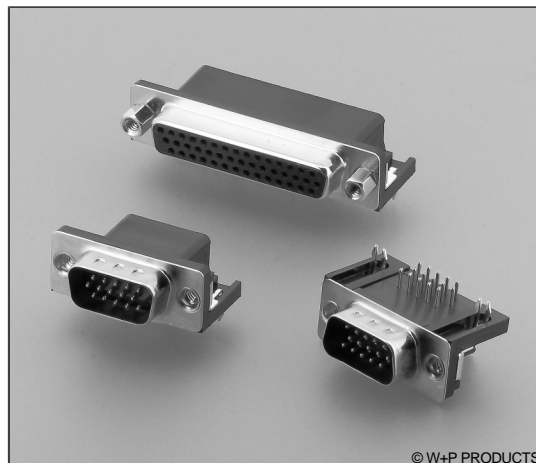

© W+P PRODUCTS

PCB-Layouts s. Tech. Info.
PCB Layouts in Tech. Info.

Buchse / Female

Stift / Male

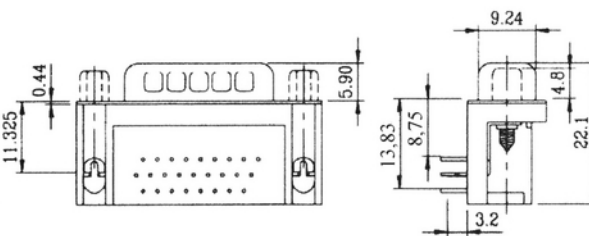
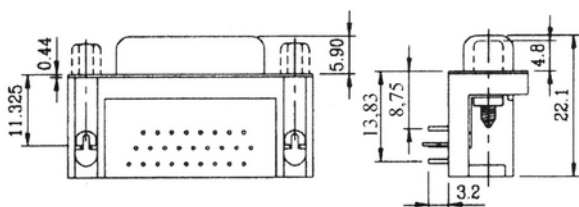
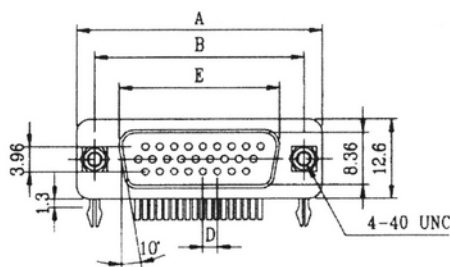
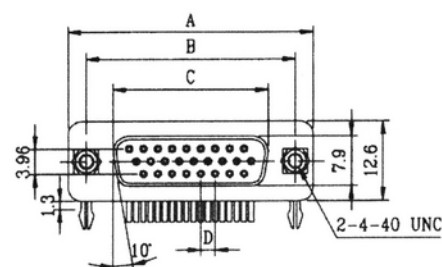

n	A	B	C	D	E
15	30,80	24,99	16,33	2,29	17,70
26	39,10	33,32	24,66	2,29	26,00
44	53,00	47,04	37,66	2,29	40,20
62	69,30	63,50	54,83	2,41	56,70

Series

110

Contacts*

44

15/26/44/62

Terminal*

1

1 Stift
Male
2 Buchse
Female

Dimensions*

1

1 Masseblech vernietet Gewindeniet UNC 4-40
Riveted grounding brackets UNC 4-40 rivet
2 Masseblech mit UNC 4-40 Gewinde
mit befestigten Bolzen (nur Bolts-Option 20),
Economy-Version
Grounding brackets with UNC 4-40 thread
with assembled bolts (only Bolts-option 20),
economy version

Bolts*

00

00 Ohne Bolzen
W/o bolts
10 Bolzen lose
Loose bolts
20 Bolzen montiert
Assembled bolts

* Dies ist ein **Bestellbeispiel** -
bitte durch Ihre Spezifikationen ersetzen.
* This is an **order example** -
please replace by your specifications.

Leiterplatten-Layouts für HD D-Sub-Verbinder

PCB Layouts for HD D-Sub Connectors

Gerade Ausführung / Straight Type

Stift / Male

Buchse / Female

15-pol.

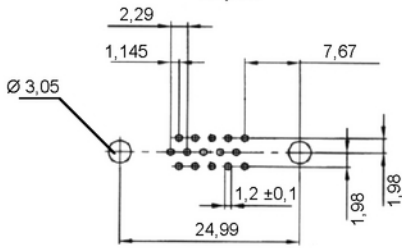

15-pol.

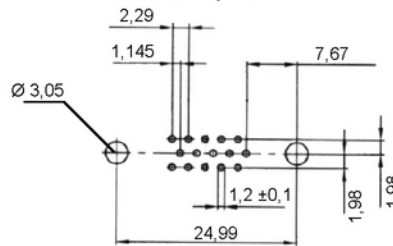

26-pol.

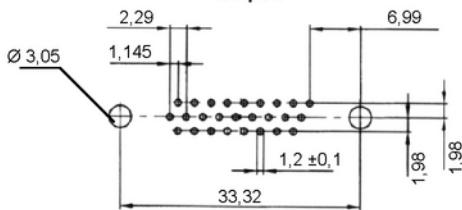

26-pol.

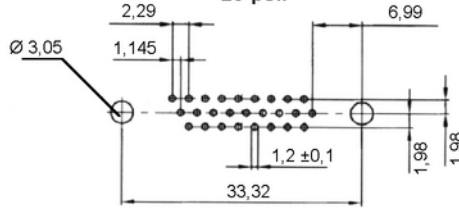

44-pol.

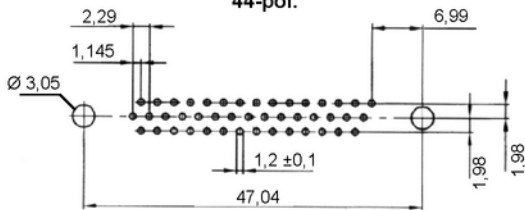

44-pol.

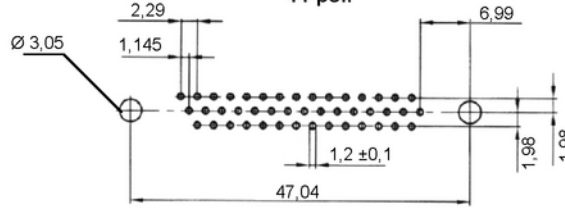

62-pol.

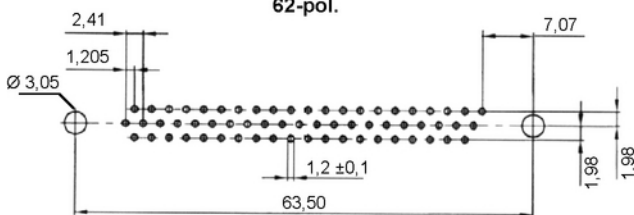

62-pol.

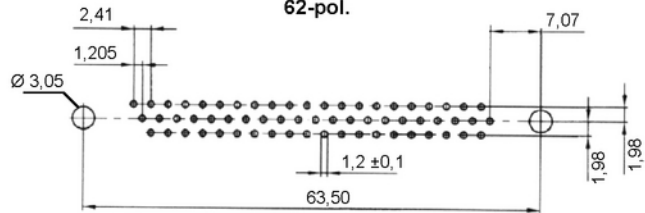

78-pol.

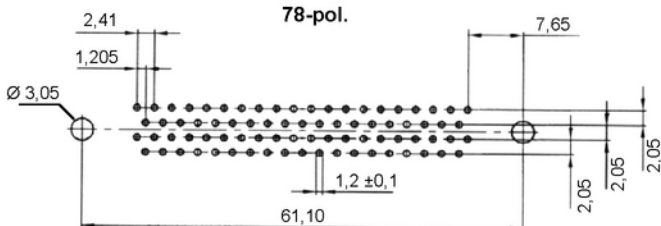

78-pol.

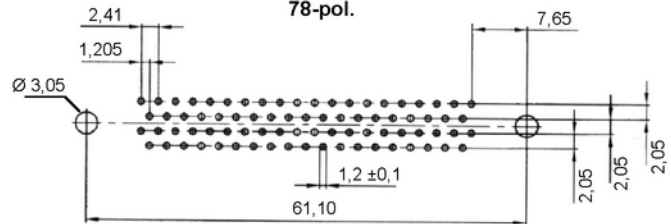

Gewinkelte Ausführung / Right-angled Type

Stift / Male

Buchse / Female

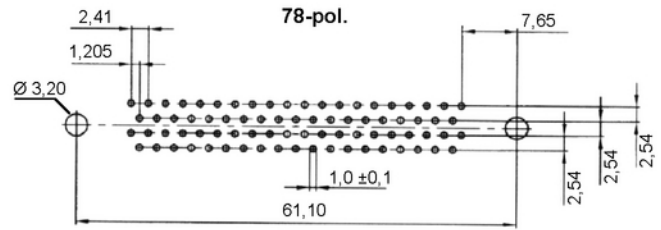
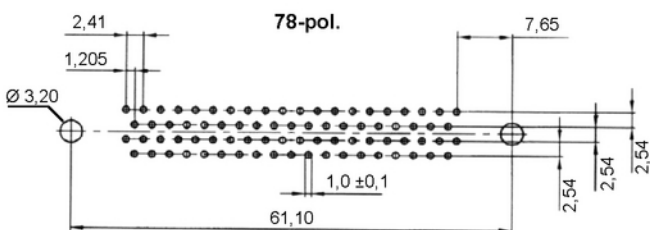
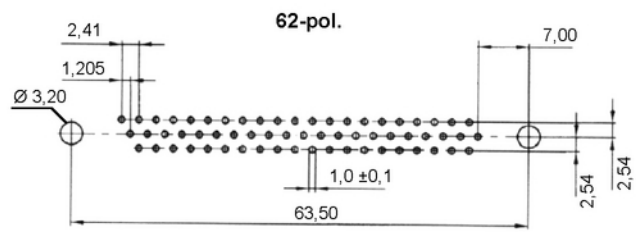
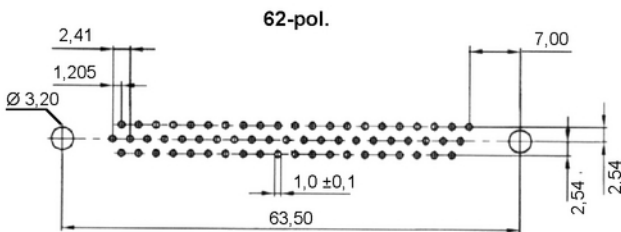
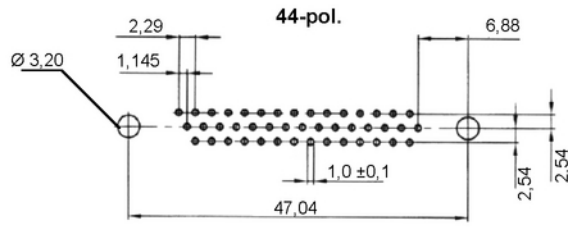
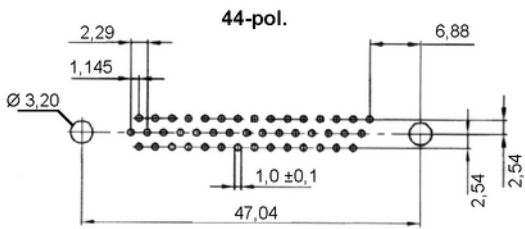
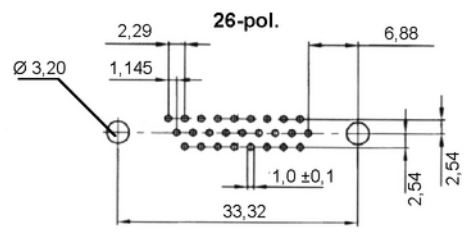
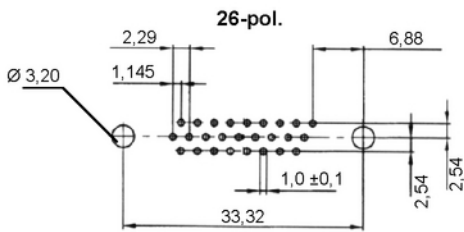
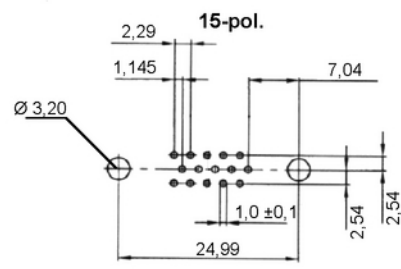
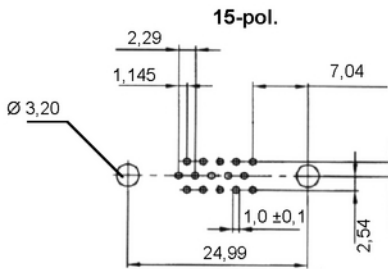

Empfehlungen für das Wellenlötverfahren

Recommendations for Wave Soldering

Die Bauteile sollten bei einer Lötbadtemperatur von 260°C in max. 5 Sekunden verlötet werden.
Items should be soldered at a solder temperature of 260°C in 5 seconds max.

Empfohlenes Wellenlötprofil:
Recommended wave soldering profile:

