

D-Sub Steckverbinder, gerade, Lötstifte – integrierter EMI-Filter D-Sub Connectors, Straight, Solder Pins – Integrated EMI Filter

Technische Daten / Technical Data

Gehäuse	Stahl vernickelt, verzinkt
Shell	Steel, tin coated over nickel
Isolierkörper	Thermoplastischer Kunststoff, nach UL94 V-0
Insulator	Thermoplastic, rated UL94 V-0
Kontaktmaterial	Kupferlegierung
Contact Material	Copper alloy
Kontaktoberfläche	Gold über Nickel
Contact Surface	Gold over nickel
Lötbarkeit	IEC 60512-12A
Solderability	IEC 60512-12A
Durchgangswiderstand	< 20mΩ
Contact Resistance	< 20mΩ
Isolationswiderstand	> 1000MΩ
Insulation Resistance	> 1000MΩ
Spannungsfestigkeit	1kV _{AC}
Test Voltage	1kV _{AC}
Nennstrom	5A
Current Rating	5A
Temperaturbereich	-55°C ... +125°C
Temperature Range	-55°C ... +125°C
Verarbeitung	Wellenlötverfahren
Processing	Wave soldering

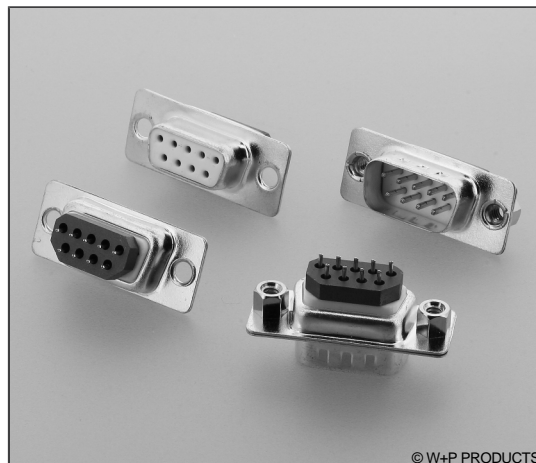

© W+P PRODUCTS

Filterkennlinie s. Tech. Info.
Filter Specification in Tech. Info.

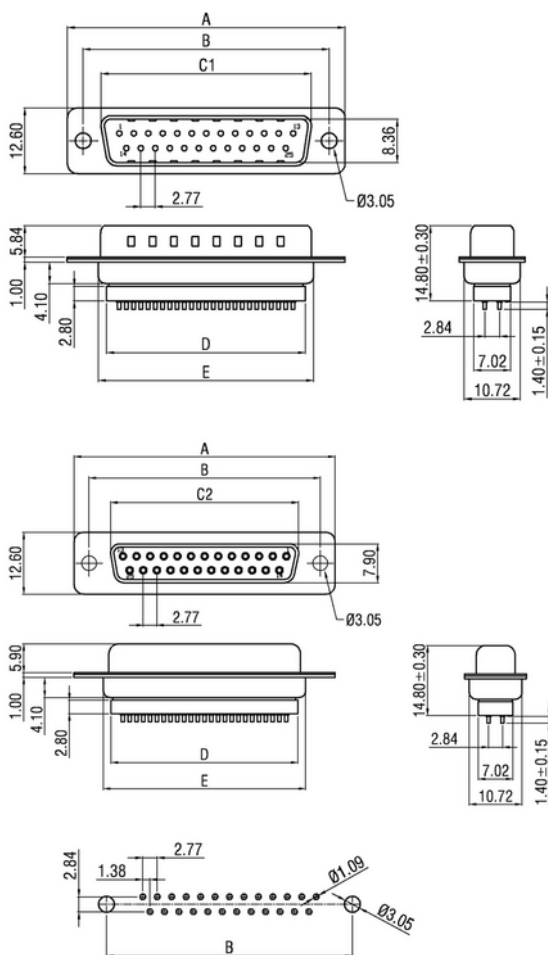

n	A	B	C1	D	E
09	30,81	24,99	16,33	19,20	15,45
15	39,14	33,52	24,66	27,70	24,45
25	53,04	47,04	38,38	41,10	38,00
37	69,32	63,50	54,84	57,30	53,96

n	A	B	C2	D	E
09	30,81	24,99	16,92	19,20	15,45
15	39,14	33,52	25,50	27,70	24,45
25	53,04	47,04	38,96	41,10	38,00
37	69,32	63,50	55,42	57,30	53,96

Series	Contacts*	Terminals*	Quality	Mounting*
345	25 09/15/25/37	1 1 Stiftkontakte Male 2 Buchsenkontakte Female	3 GK 3 Min. 50 Steckzyklen Min. 50 cycles Andere Güteklassen auf Anfrage More quality classes on request	0 0 ... CL Lt. Tech. Info. See Tech. Info.

* Dies ist ein **Bestellbeispiel** -
bitte durch Ihre Spezifikationen ersetzen.
* This is an **order example** -
please replace by your specifications.

D-Sub / HD D-Sub EMI-Filter Spezifikationen

EMI Filter Specifications

Entstörfilter / EMI Filters

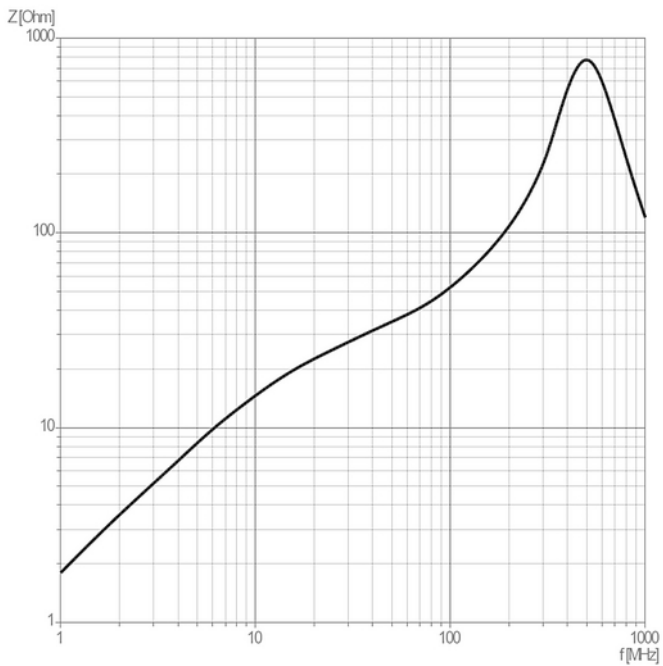

Filtertyp <i>Filter Type</i>	Ferrit-Ringkern, 1 Windung / Leiter <i>Ferrite Toroidal Core, 1 Turn / Conductor</i>
Testbereich / Test Range <i>Testleiter / Test Conductor</i>	1MHz ... 1000MHz 1 x AWG18x80mm
Induktiver Widerstand (typ.) bei 25MHz <i>Inductive Resistance (typ.) @ 25MHz</i>	25 Ohm (18 Ohm min.)
Ohm'scher Widerstand (typ.) bei 25MHz <i>Ohmic Resistance (typ.) @ 25MHz</i>	0,88 Ohm
Induktiver Widerstand (typ.) bei 100MHz <i>Inductive Resistance (typ.) @ 100MHz</i>	51 Ohm (40 Ohm min.)
Ohm'scher Widerstand (typ.) bei 100MHz <i>Ohmic Resistance (typ.) @ 100MHz</i>	0,70 Ohm

Durchgangsloch / Through Hole

0 Durchgangsloch 3,05mm
3.05mm Through Hole

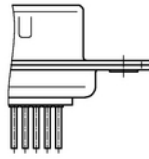

Gewindeniet vorn / Thread Rivet Front

B1 Gewindeniet UNC 4-40
UNC 4-40 Thread Rivet
B2 Gewindeniet M3
M3 Thread Rivet

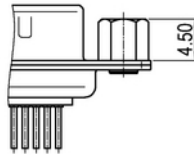

Gewindeniet hinten / Thread Rivet Back

1 Gewindeniet UNC 4-40
UNC 4-40 Thread Rivet
2 Gewindeniet M3
M3 Thread Rivet

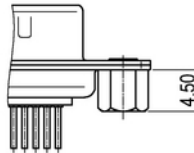

Gewindebolzen vorn / Thread Bolt Front

3 Gewindebolzen UNC 4-40
UNC 4-40 Thread Bolt
4 Gewindebolzen M3
M3 Thread Bolt

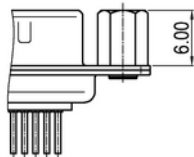

Gewindebolzen hinten / Thread Bolt Back

5 Gewindebolzen UNC 4-40
UNC 4-40 Thread Bolt
6 Gewindebolzen M3
M3 Thread Bolt

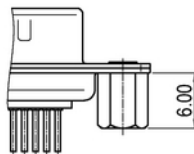

Board Lock

BL Board Lock mit UNC 4-40 Gewinde
Board Lock with UNC 4-40 Thread

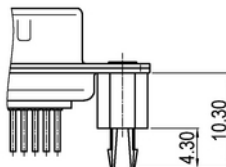

Combi-Lock

CL Combi-Lock mit UNC 4-40 Gewinde
Combi Lock with UNC 4-40 Thread

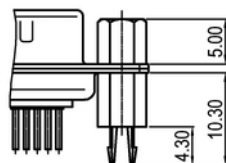

Empfehlungen für das Wellenlötverfahren

Recommendations for Wave Soldering

Die Bauteile sollten bei einer Lötbadtemperatur von 260°C in max. 5 Sekunden verlötet werden.
Items should be soldered at a solder temperature of 260°C in 5 seconds max.

Empfohlenes Wellenlötprofil:
Recommended wave soldering profile:

