

HD D-Sub Steckverbinder, gewinkelt, Lötstifte – integrierter EMI-Filter HD D-Sub Connectors, Right-Angled, Solder Pins – Integrated EMI-Filter

Technische Daten / Technical Data

Gehäuse	Stahl vernickelt, verzinkt
Shell	Steel, tin coated over nickel
Isolierkörper	Thermoplastischer Kunststoff, nach UL94 V-0
Insulator	Thermoplastic, rated UL94 V-0
Kontaktmaterial	Kupferlegierung
Contact Material	Copper alloy
Kontaktoberfläche	Gold über Nickel
Contact Surface	Gold over nickel
Lötbarkeit	IEC 60512-12A
Solderability	IEC 60512-12A
Durchgangswiderstand	< 20mΩ
Contact Resistance	< 20mΩ
Isolationswiderstand	> 1000MΩ
Insulation Resistance	> 1000MΩ
Spannungsfestigkeit	1kV _{AC}
Test Voltage	1kV _{AC}
Nennstrom	5A
Current Rating	5A
Temperaturbereich	-55°C ... +125°C
Temperature Range	-55°C ... +125°C
Verarbeitung	Wellenlötverfahren
Processing	Wave soldering
Güteklasse	GK 3, min. 50 Steckzyklen, andere GK auf Anfrage
Quality Class	Quality class 3, min. 50 cycles, more quality options on request

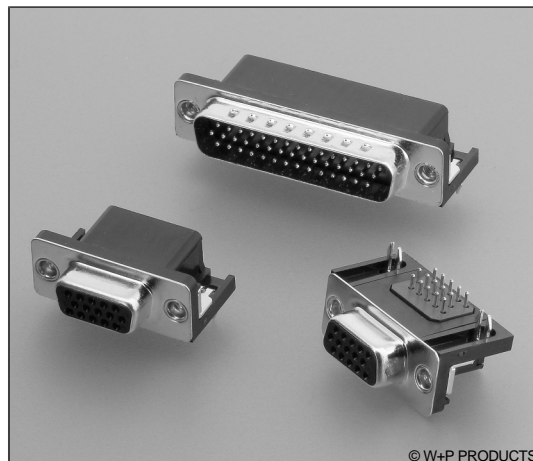

© W+P PRODUCTS

PCB-Layouts und Kennlinie s. s. Tech. Info.
PCB Layouts and Filter Specs. in Tech. Info.

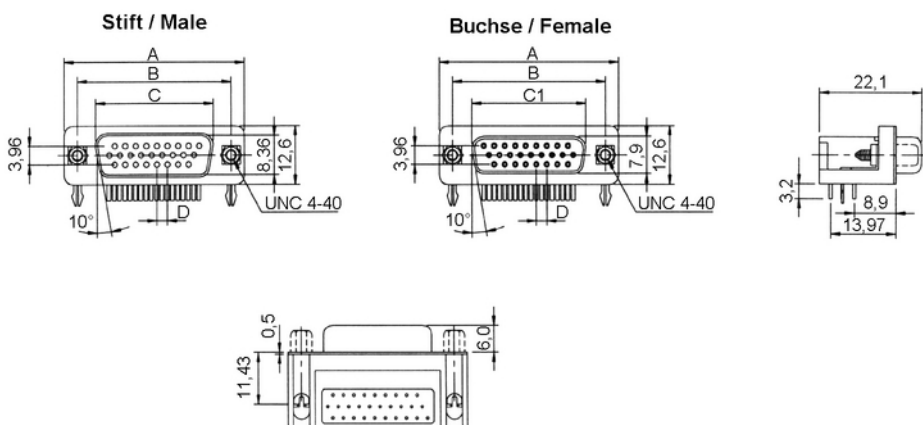

n	A	B	C	C1	D
15	30,80	24,99	16,92	16,33	2,29
26	39,10	33,32	25,25	24,66	2,29
44	53,00	47,04	38,25	37,66	2,29
62	69,30	63,50	55,42	54,84	2,41

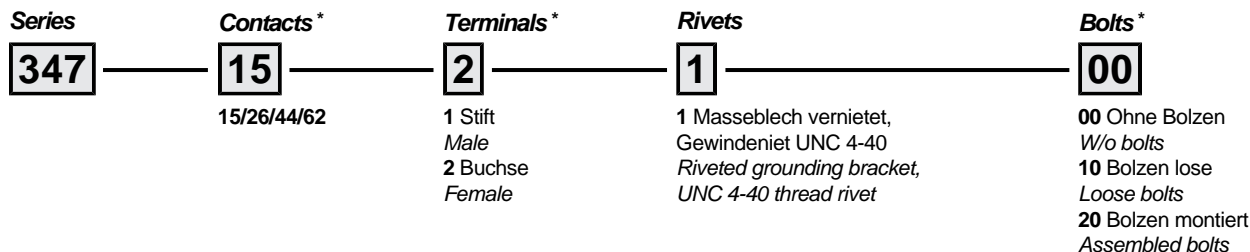

* Dies ist ein **Bestellbeispiel** - bitte durch Ihre Spezifikationen ersetzen.
* This is an **order example** - please replace by your specifications.

D-Sub / HD D-Sub EMI-Filter Spezifikationen

EMI Filter Specifications

Entstörfilter / EMI Filters

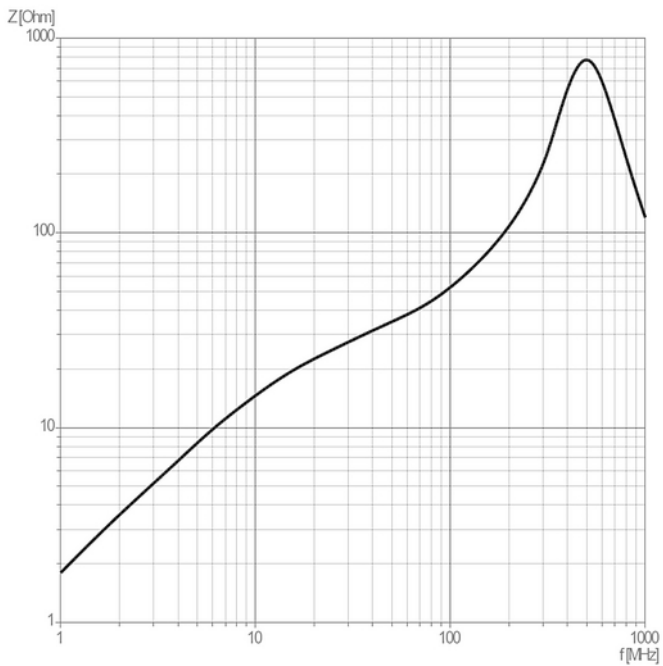

Filtertyp <i>Filter Type</i>	Ferrit-Ringkern, 1 Windung / Leiter <i>Ferrite Toroidal Core, 1 Turn / Conductor</i>
Testbereich / Test Range <i>Testleiter / Test Conductor</i>	1MHz ... 1000MHz 1 x AWG18x80mm
Induktiver Widerstand (typ.) bei 25MHz <i>Inductive Resistance (typ.) @ 25MHz</i>	25 Ohm (18 Ohm min.)
Ohm'scher Widerstand (typ.) bei 25MHz <i>Ohmic Resistance (typ.) @ 25MHz</i>	0,88 Ohm
Induktiver Widerstand (typ.) bei 100MHz <i>Inductive Resistance (typ.) @ 100MHz</i>	51 Ohm (40 Ohm min.)
Ohm'scher Widerstand (typ.) bei 100MHz <i>Ohmic Resistance (typ.) @ 100MHz</i>	0,70 Ohm

Gerade Ausführung / Straight Type

Stift / Male

Buchse / Female

15-pol.

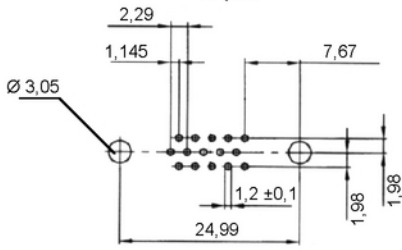

15-pol.

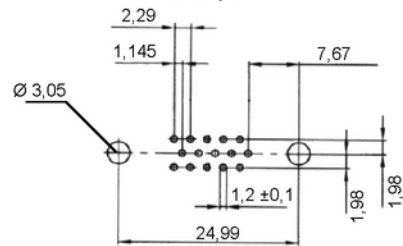

26-pol.

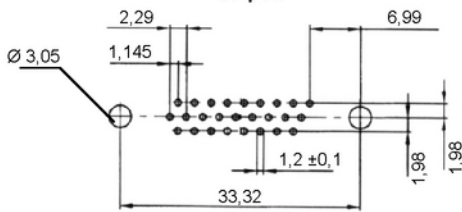

26-pol.

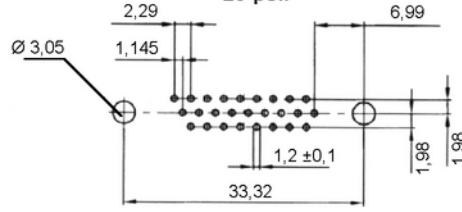

44-pol.

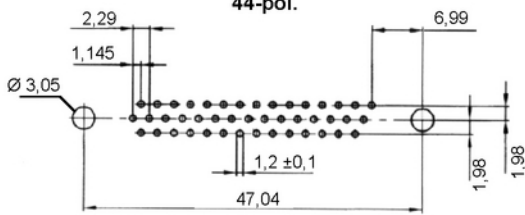

44-pol.

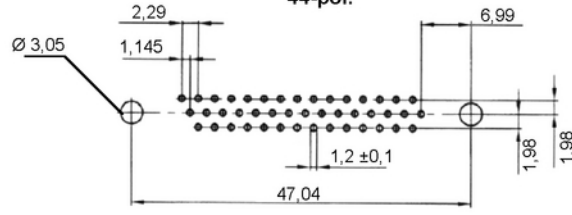

62-pol.

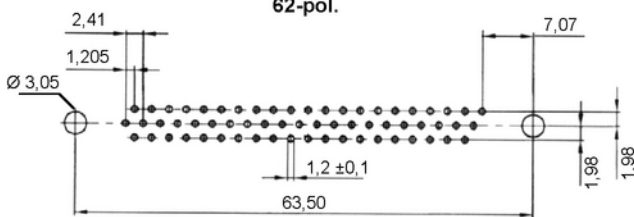

62-pol.

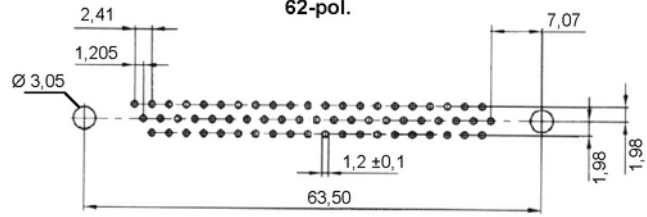

78-pol.

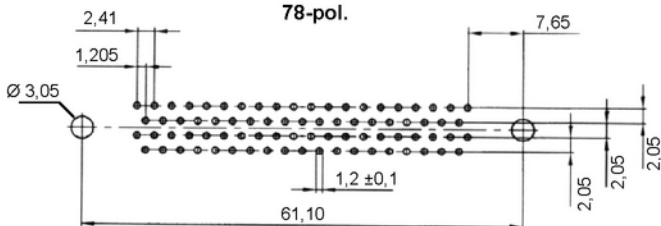

78-pol.

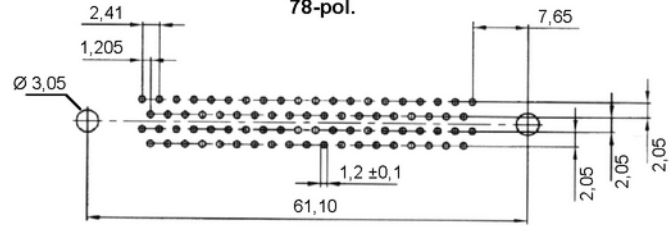

Gewinkelte Ausführung / Right-angled Type

Stift / Male

Buchse / Female

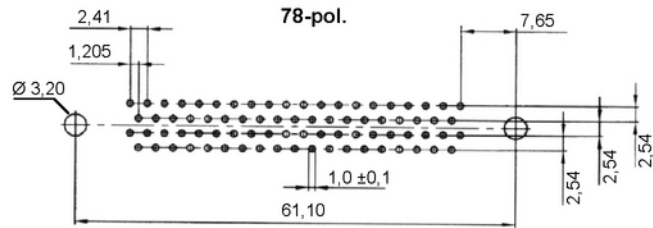
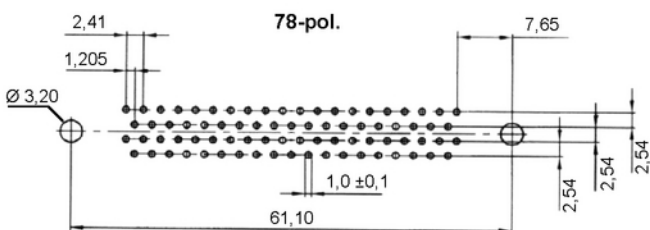
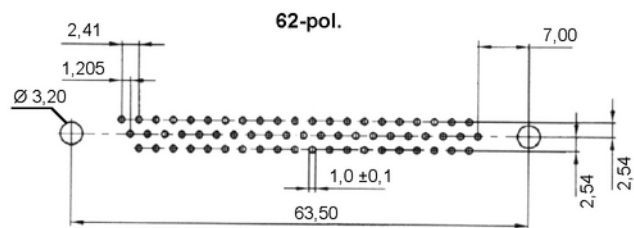
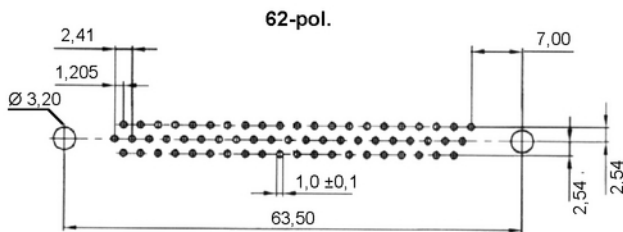
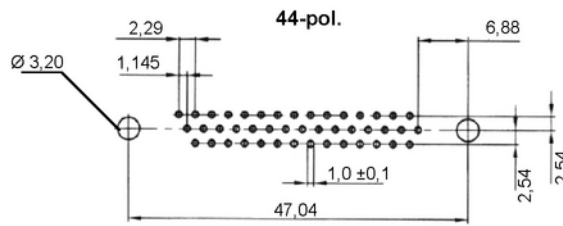
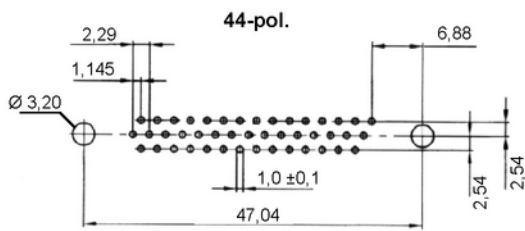
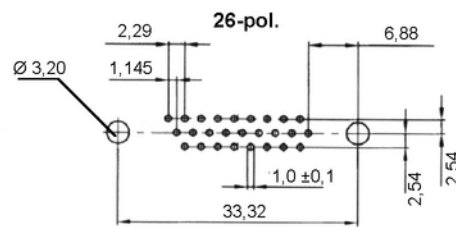
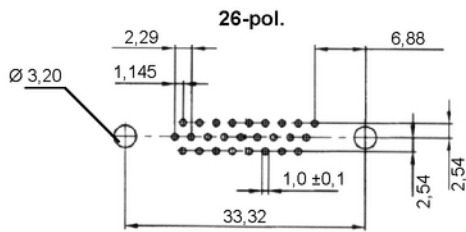
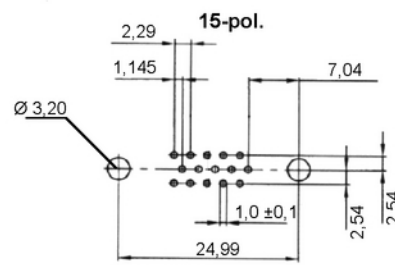
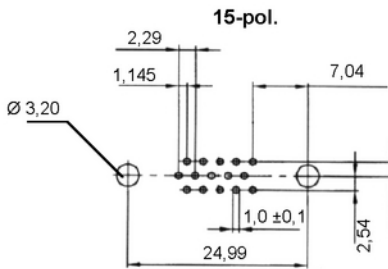

Empfehlungen für das Wellenlötverfahren

Recommendations for Wave Soldering

Die Bauteile sollten bei einer Lötbadtemperatur von 260°C in max. 5 Sekunden verlötet werden.
Items should be soldered at a solder temperature of 260°C in 5 seconds max.

Empfohlenes Wellenlötprofil:
Recommended wave soldering profile:

