

## Crimp-Rast-Stiftgehäuse 2-reihig RM 4,20mm Friction Lock Male Housings, 4.20mm Pitch

### Technische Daten / Technical Data

Isolierkörper <i>Insulator</i>	Thermoplast, nach UL94 V-2 (V-0 auf Anfr.) <i>Thermoplastic, rated UL94 V-2 (V-0 on request)</i>
Kontaktmaterial <i>Contact Material</i>	Kupferlegierung <i>Copper alloy</i>
Kontaktoberfläche <i>Contact Surface</i>	Lt. Oberflächenoptionen, über Ni (1,3 ... 2,5µm) <i>Acc. to options (see below), over Ni (1.3 ... 2.5µm)</i>
Aderquerschnitt <i>Applicable wire Gauge</i>	Lt. Optionen <i>Lt. Optionen</i>
Durchgangswiderstand <i>Contact Resistance</i>	< 20mΩ <i>&lt; 20mΩ</i>
Isolationswiderstand <i>Insulation Resistance</i>	> 1000MΩ <i>&gt; 1000MΩ</i>
Spannungsfestigkeit <i>Test Voltage</i>	1500V <sub>AC</sub> <i>1500V<sub>AC</sub></i>
Nennspannung <i>Voltage Rating</i>	600V <sub>AC</sub> <i>600V<sub>AC</sub></i>
Nennstrom <i>Current Rating</i>	bis zu 9A (abhängig vom AWG-Bereich) <i>up to 9A (Dependent on AWB-Range)</i>
Temperaturbereich <i>Temperature Range</i>	-40°C ... +105°C <i>-40°C ... +105°C</i>

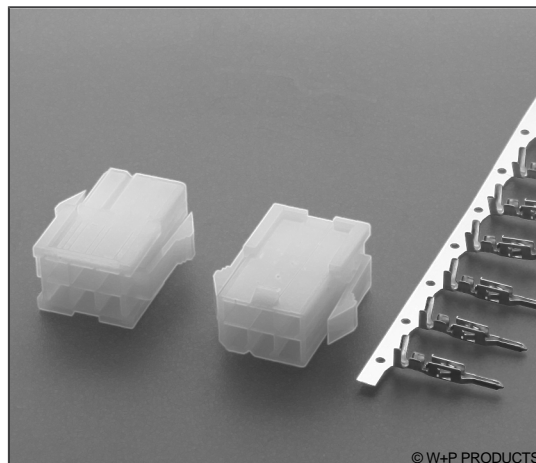

© W+P PRODUCTS

Passende Gegenstecker:  
Compatible Connectors:

580

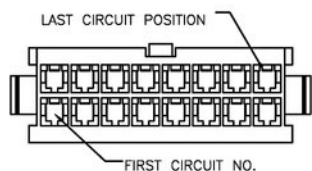
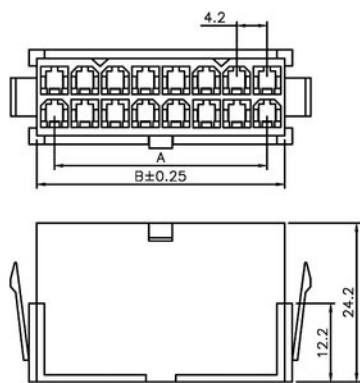

Circuits	Dim.A	Dim.B
2		5.50
4	4.20	9.70
6	8.40	13.90
8	12.60	18.10
10	16.80	22.30
12	21.00	26.50
14	25.20	30.70
16	29.40	34.90
18	33.60	39.10
20	37.80	43.30
22	42.00	47.50
24	46.20	51.70

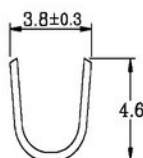
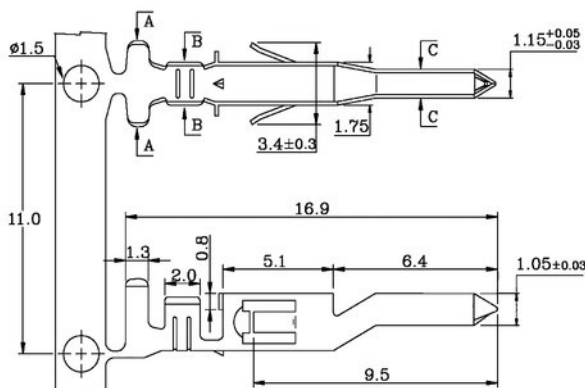

Section A-A

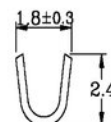

Section B-B

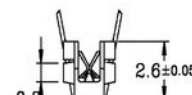

Section C-C

AWG	n			
	02	04/06	08/10	12-24
18	9A	8A	7A	6A
20	7A	6A	5A	
22	5A	4A		
24	4A	3A		

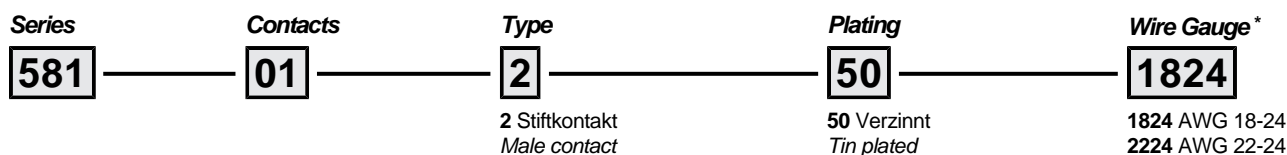
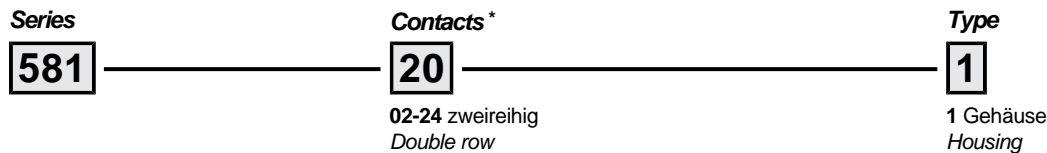

\* Dies ist ein **Bestellbeispiel** -  
bitte durch Ihre Spezifikationen ersetzen.  
\* This is an **order example** -  
please replace by your specifications.