

820

Anschlußklemmen RM 5,0 / 10,0 mm - Kabelanschluß vorne

Terminal Blocks for PCB - Pitch 5,0 / 10,0 mm - Front Wire Inlet Type

Technische Daten / Technical Data:

Gehäuse	PBT glasfaserverstärkt, selbstverlöschend nach UL94V0
Case	PBT glass fiber filled, self extinguishing rated UL94V0
Farbe	grün, weitere Farben und Beschriftung auf Anfrage
Colour	green, more colours and marking possibilities upon request
Kontaktmaterial	Messing CuNi, verzinkt
Contact Material	Brass CuNi, tin plated
Drahtschutz	CuSn6
Wire Guard	
Lötanschluß	verzinkt
Solder Tail	tin plated
Klemmschraube	galvanisierter und verchromter Stahl
Terminal Screw	steel galvanized and chromated
Nennspannung	250 V
Rated Voltage	
Nennstrom	16 A
Current Rating	
Temperaturbereich	-30°C ... +120°C
Temperature Range	
AWG-Bereich	AWG 22-14
AWG-Range	

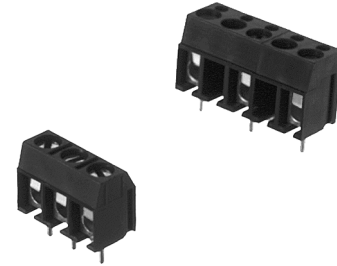

© W+P PRODUCTS

Height: 12,5 mm

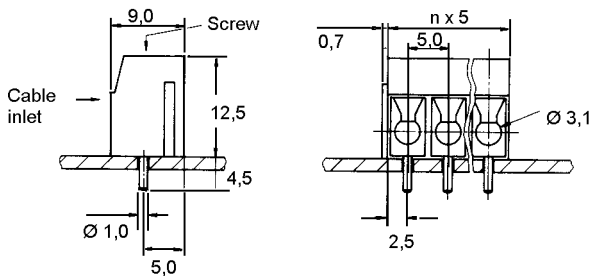

Height: 10,0 mm

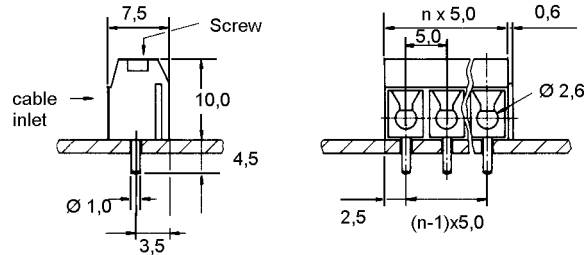

PCB-Layout

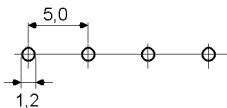

PCB-Layout

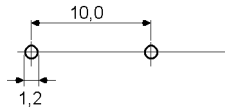

n = Anzahl Kontakte
n = No. of Contacts

Series	Contacts*	Height*	Pitch*
820	03	125	05

02-03-pol.

100 = Bauhöhe 10,0 mm
Height 10,0 mm
125 = Bauhöhe 12,5 mm
Height 12,5 mm

05 = Raster 5,0 mm
Pitch 5,0 mm
10 = Raster 10,00 mm
Pitch 10,00 mm

Anreihbar bis max. 24-pol.
Stackable up to max. 24-pol.

Auch im Raster 5,08 mm lieferbar.
Also available with 5,08 mm pitch.

(* Bestellbeispiel - Bitte durch Ihre Spezifikationen ersetzen.
* Order example - To be replaced by your specifications.)

TEL.: +49 5223 98507-0
FAX : +49 5223 98507-50

W+P PRODUCTS

E-MAIL: sales@wpro.com
INTERNET: www.wpro.com