

Characteristics

- Light emission in the direction of 45° angle
- High optical efficiency
- Toyoda Gosei InGaN core emitter
- Silicone encapsulation

Directive Characteristics (Ta=25°C)

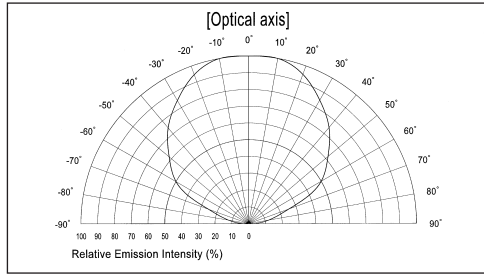

Package Outlines (mm)

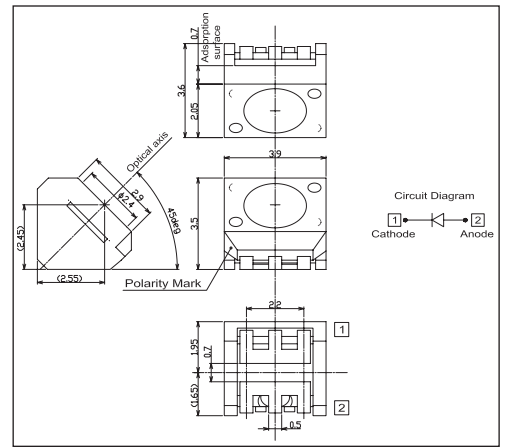

Absolute Rating Limits (Ta=25°C)

Item	Symbol	Value	Unit
Power Dissipation	P _D	120	mW
DC Forward Current	I _F	30	mA
DC Reverse Voltage	V _R	5	V
Operating Temperature	T _{opr}	-40 ~ +100	°C
Storage Temperature	T _{stg}	-40 ~ +100	°C

Recommended Soldering Pattern (mm)

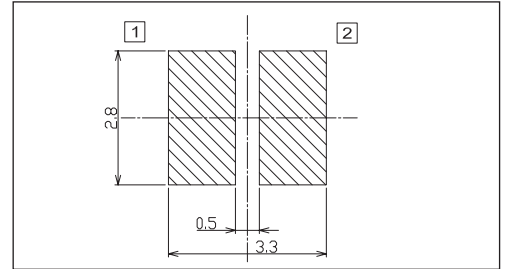

Electrical and Optical Characteristics (Ta=25°C)

Part No.	Luminous Intensity [mcd]			Forward Voltage [V]			Wavelength Characteristics [nm]			
	Typ.	Min.	I _F [mA]	Typ.	Max.	I _F [mA]	λ _D Min.	λ _D Max.	Δλ Typ.	I _F [mA]
PX-1A545-G	900	560	20	3.4	4.0	20	520	540	35	20

Luminous Intensity Ranks (Ta=25°C)

Luminous Intensity [mcd] at I _F =20mA					
Rank		Rank		Rank	
N	560 ~ 820	O	820 ~ 1200	P	1200 ~ 1800

Taping Outline Dimensions (Unit: mm)

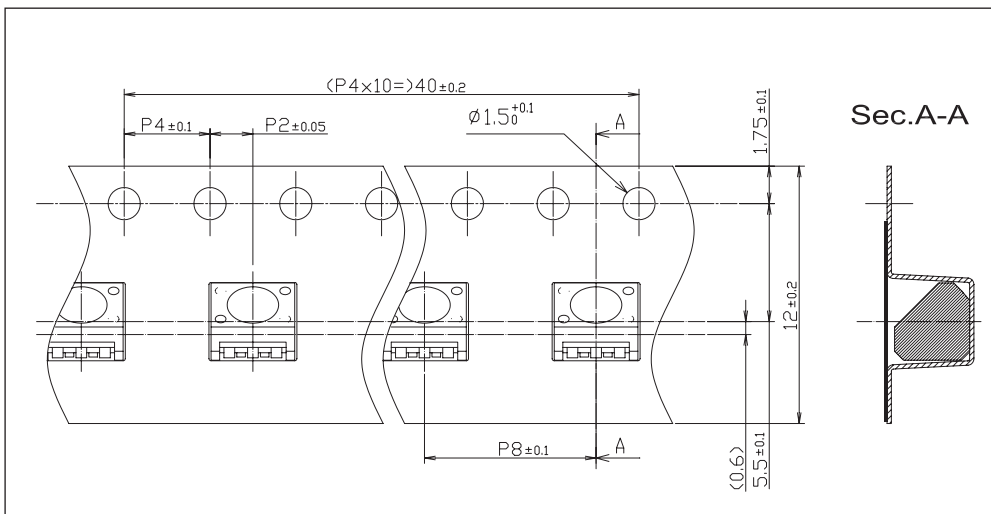

Package

Reel	1500 pieces / reel
------	--------------------

Typical Characteristics

