



SPECIFICATIONS

POLE-POSITION : Momentary Type, SPST with LED

CONTACT RATING : 30V DC, 0.1A

CONTACT RESISTANCE : 50mΩ max. 1.5V DC ; 100mA,
by Method of Voltage DROP

INSULATION RESISTANCE : 100 MΩ min. 500V DC

DIELECTRIC STRENGTH : 500V AC for 1 Minute

OPERATING FORCE : 250±100gf

OPERATING LIFE : 50,000 cycles

OPERATING TEMPERATURE RANGE : -40°C ~ 85°C

TOTAL TRAVEL : 1.2±0.3mm

Materials

CAP : PC

CASE & HOUSING : Nylon 6/6

TERMINALS : Copper alloy with gold plated.

HOW TO ORDER

MODEL NO. LED COLOR

PBL



Led color

ITEM NO	COLOR
01	White
03	Red
05	Yellow
06	Green
07	Blue
76	Blue (Green)

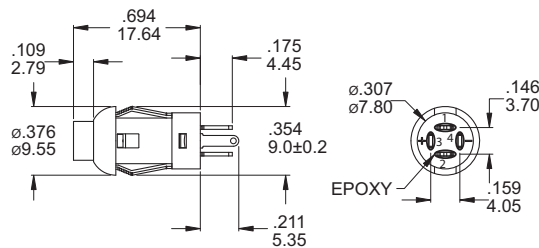
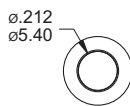
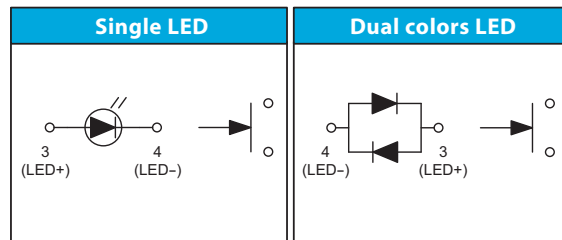

PANEL MOUNTING

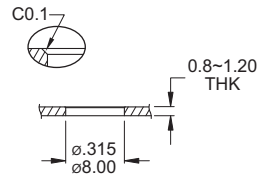

Part No. Shown : PBL-XX

WITH LED ELECTRO-OPTICAL DATA

* The LED specification for reference only

Lens Appearance	Color	Electro-optical Data (AT 20mA)				Peak Wavelength	Viewing Angle 2θ 1/2 (deg)
		Vf (V)		Iv (mcd)			
		Typ.	Max.	Typ.	Min.		
Water Clear	White	3.30	4.00	1500	900	X/Y=0.31	35°
	Red	1.95	2.50	130	700		
	Yellow	2.10	2.50	25	12		
	Green	2.10	2.50	300	100		
	Blue	3.30	4.00	1300	470		
Blue (Green)	B	3.3	4.0	160	80	470	60°
	G	2.1	2.5	80	30		

