

IDC Schneid-Klemm Buchsengehäuse und Stiftheisen RM 2,54mm IDC Friction Lock Female Headers and Pin Headers 2.54mm Pitch

Technische Daten / Technical Data

Isolierkörper	Thermoplast, UL94 V-2, weiß (Type 01-04, 09) Thermoplast, UL94 V-0, weiß (Type 05, 06) Thermoplast, UL94 V-0, schwarz (Type 07, 08)
Insulator	Thermoplastic, UL94 V-2, white (Type 01-04, 09) Thermoplastic, UL94 V-0, white (Type 05, 06) Thermoplastic, UL94 V-0, black (Type 07, 08)
Kontaktmaterial	Vierkantstift 0,635mm, Kupferlegierung
Contact Material	0.635mm square pin, copper alloy
Kontaktfläche	Lt. Oberflächenoptionen, über Ni
Contact Surface	Acc. to plating options, over Ni
Aderquerschnitt	AWG 28 ~ 22
Applicable wire Gauge	AWG 28 ~ 22
Durchgangswiderstand	< 20 mΩ
Contact Resistance	< 20 mΩ
Isolationswiderstand	> 1000 MΩ
Insulation Resistance	> 1000 MΩ
Spannungsfestigkeit	700 V AC
Test Voltage	700 V AC
Nennspannung	250 V AC
Voltage Rating	250 V AC
Nennstrom	Bis zu 3 A
Current Rating	Up to 3 A
Temperaturbereich	-25 °C ... +85 °C -40 °C ... +105 °C (Type 07, 08)
Temperature Range	-25 °C ... +85 °C -40 °C ... +105 °C (Type 07, 08)
Verarbeitung	Wellenlötverfahren
Processing	Wave soldering

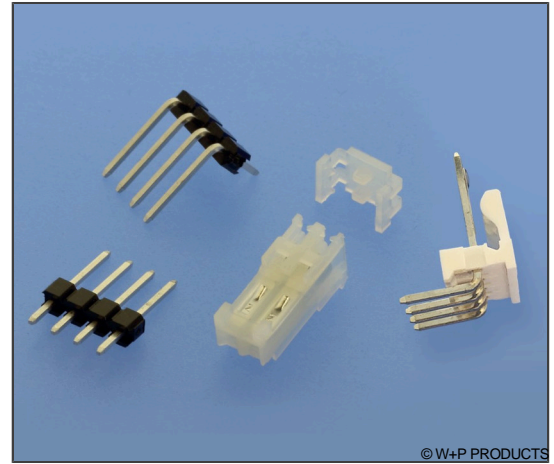

© W+P PRODUCTS

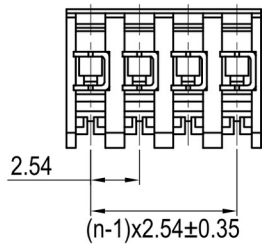

Type -01-

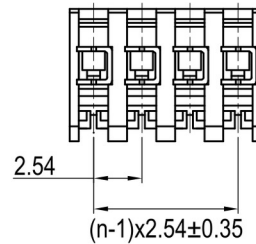

Type -02-

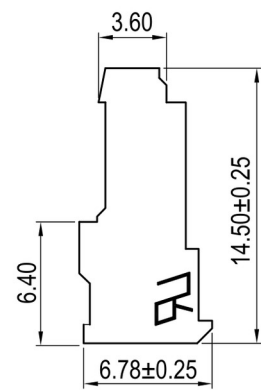
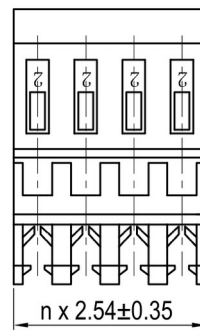
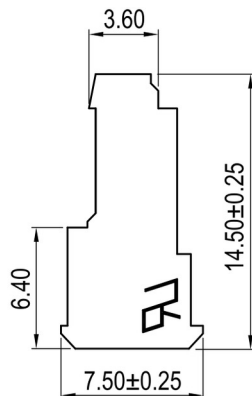
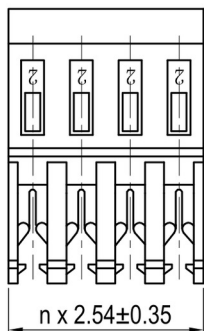

Nicht anreihbar / not stackable in the grid

AWG Markierung auf den Kontakten / AWG marking on contacts - 2: AWG22, 4: AWG 24, 6: AWG26/28

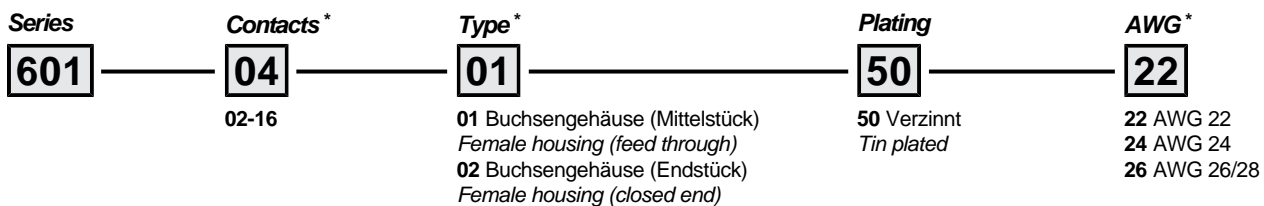

601

IDC Schneid-Klemm Buchsengehäuse und Stiftleisten RM 2,54mm

IDC Friction Lock Female Headers and Pin Headers 2.54mm Pitch

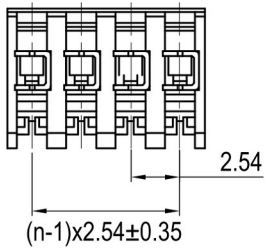

Type -03-

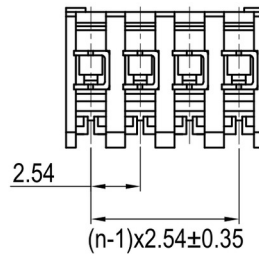

Type -04-

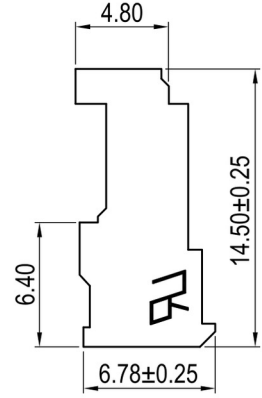
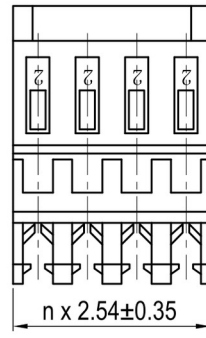
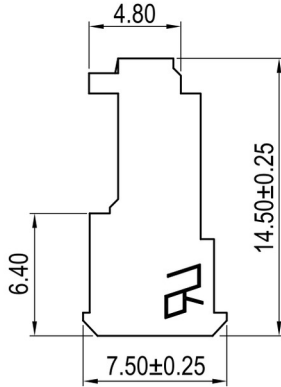
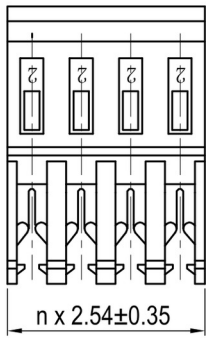

Nicht anreihbar / not stackable in the grid

AWG Markierung auf den Kontakten / AWG marking on contacts - 2: AWG22, 4: AWG 24, 6: AWG26/28

Series	Contacts*	Type*	Plating	AWG*
601	04 02-16	03 03 Buchsengehäuse (Mittelstück) mit Codierung Female housing (feed through) with coding 04 Buchsengehäuse (Endstück) mit Codierung Female housing (closed end) with coding	50 50 Verzinkt Tin plated	22 22 AWG 22 24 AWG 24 26 AWG 26/28

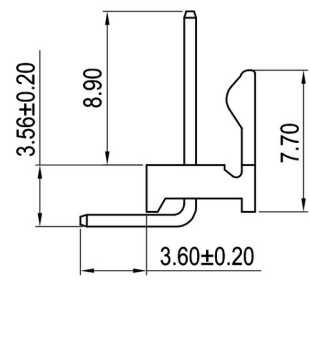
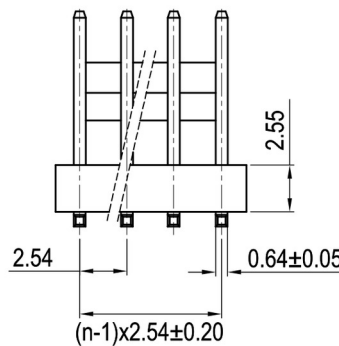
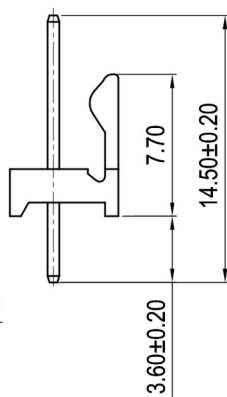
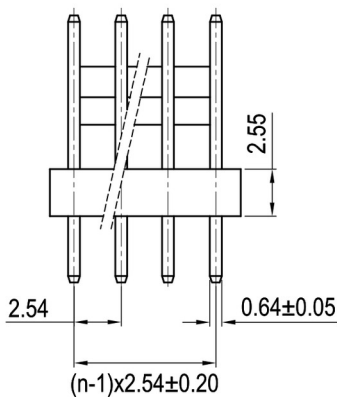
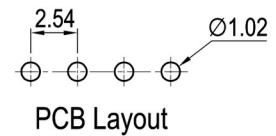
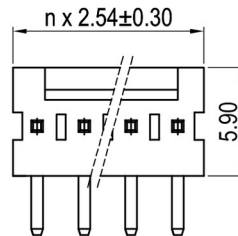
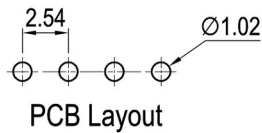
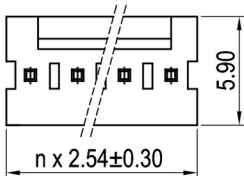

Series	Contacts*	Type*	Plating
601	04 02-16	05 05 Stiftleiste gerade, mit Verriegelung und Kodierung Pin header straight, with locking and coding 06 Stiftleiste gewinkelt, mit Verriegelung und Kodierung Pin header right-angled, with locking and coding	50 50 Verzinkt Tin plated

IDC Schneid-Klemm Buchsengehäuse und Stiftleisten RM 2,54mm IDC Friction Lock Female Headers and Pin Headers 2.54mm Pitch

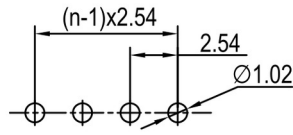
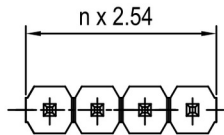

PCB Layout

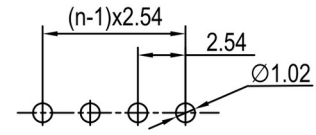
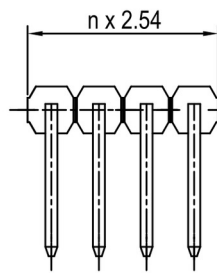

PCB Layout

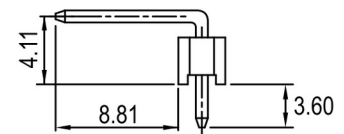
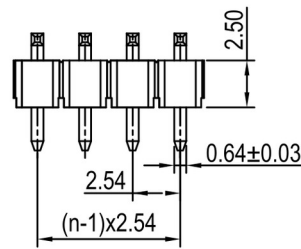
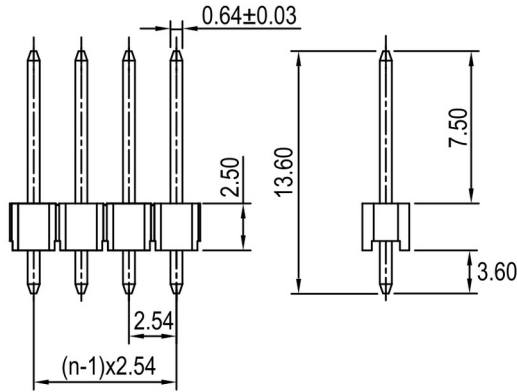

Series

601

Contacts*

04

02-40

Type*

07

07 Stiftleiste gerade
Pin header straight
08 Stiftleiste gewinkelt
Pin header right-angled

Plating

50

50 Verzinkt
Tin plated

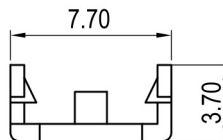
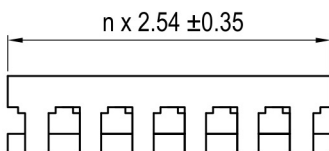
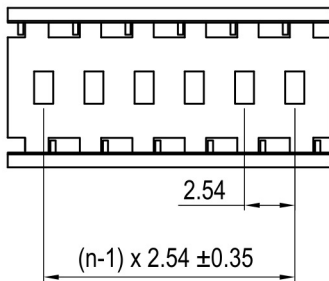

Series

601

Contacts*

04

02-16

Type

09

09 Kappe für Buchsengehäuse
Cap for female housings

* Dies ist ein **Bestellbeispiel** - bitte durch Ihre Spezifikationen ersetzen.
* This is an **order example** - please replace by your specifications.